









VAIA Wall elbow - Brushed Champagne (22kt Gold)

28 450 809
Product version from 7/6/2018

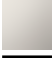

- 3/8" shower outlet
  - rosette Ø 60 mm
  - 1/2" connection
  - WRAS

Intrinsic protection against back flow.

	Brushed Champagne (22kt Gold)	28 450 809-46
	Chrome	28 450 809-00
	Brushed Platinum	28 450 809-06
	Platinum	28 450 809-08
	Dark Chrome	28 450 809-19
	Brushed Durabronze (23kt Gold)	28 450 809-28
	Brushed Bronze	28 450 809-42
	Champagne (22kt Gold)	28 450 809-47
	Brushed Dark Platinum	28 450 809-99

Recommended miscellaneous



- Concealed wall elbow -
  - min. recess depth mm
  - max. recess depth mm

35 085 970 90

VAIA Wall elbow - Brushed Champagne (22kt Gold)

28 450 809
Product version from 7/6/2018

mm [inches]



Flow rate chart



Codes & Standards

ASME A112.18.1	cUPC	EN 1717	Scottish Water Byelaws
----------------	------	---------	------------------------

UK Water Supply Regulations



## VAIA Wall elbow - Brushed Champagne (22kt Gold)

---

28 450 809 Product version from 7/6/2018

### Certificates

---

Belgaqua\_22\_280\_2 IAPMO\_4976

WRAS\_240702

# VAIA Wall elbow - Brushed Champagne (22kt Gold)

28 450 809    Product version from 7/6/2018

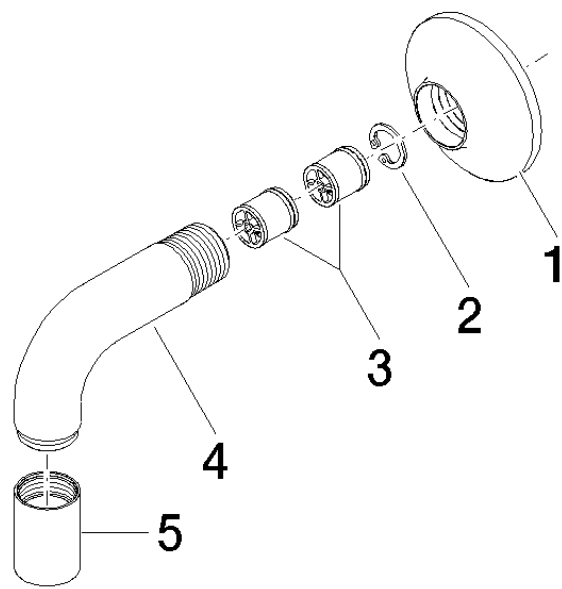

## Spare parts list

No.	Item Number	Name	Quantity used	Delivery time
1	90 27 80 021 00-46	rosette	1	30
2	09 16 01 014 90	ring	1	2
3	90 23 01 141 00 90	back-flow preventer	2	2
4	09 11 03 123-46	connection	1	30
5	90 21 02 069 00-46	cover	1	30