

MEM Bath cascade spout for wall mounting - Chrome

MEM

13 430 730

- 220mm projection
- cascade
- plate 78 mm x 192 mm
- 1/2" connection
- plug-link mounting
- max. flow 26.5 l/min at 3 bar flow pressure



Recommended miscellaneous

Concealed wall elbow - 35 085 970 90



- max. recess depth 163 mm
- min. recess depth 90 mm

13 430 730

mm [inches]

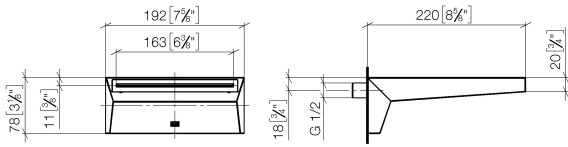

Flow rate chart

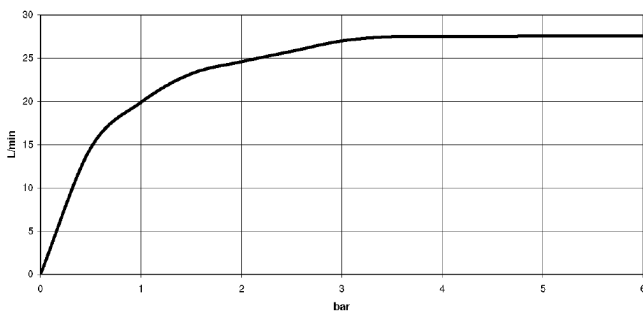

Trajectory diagram

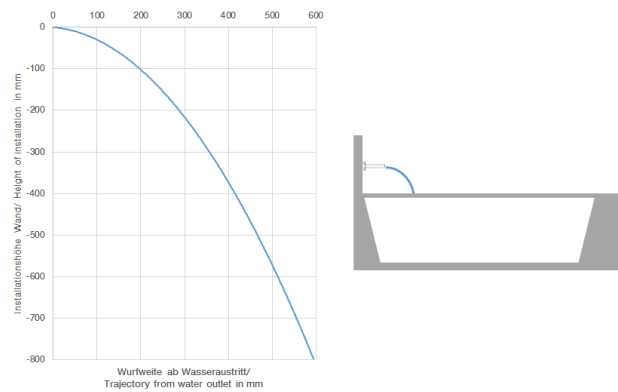

Codes & Standards

ASME A112.18.1

cUPC

DIN 4109

ISO 3822

Ü-Zeichen



MEM Bath cascade spout for wall mounting - Chrome

MEM

13 430 730

Certificates

LGA_19

IAPMO_4976

13 430 730

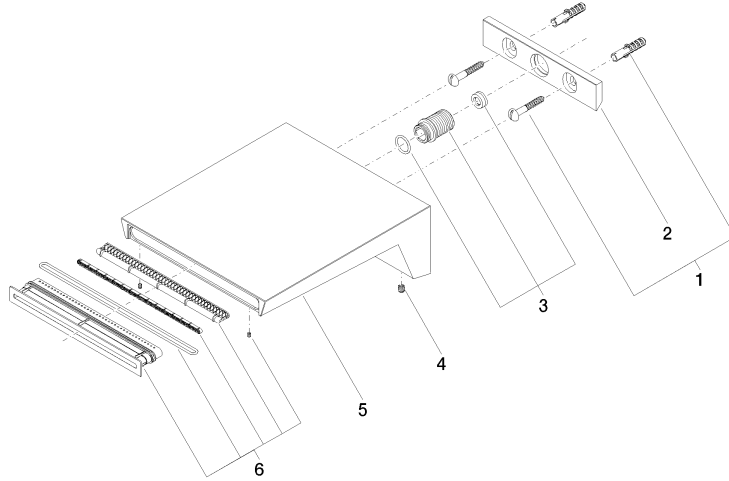



MEM Bath cascade spout for wall mounting - Chrome

MEM

13 430 730

Spare parts list

No.	Item Number	Name	Quantity used	Delivery time
	04 30 31 024 01 90	fixing set	8	2