

Deck valve anti-clockwise closing hot - Chrome

CL.1

20 000 741



- hole diameter 32 mm
- handle Ø 60mm
- without rosette
- with hot marking
- WRAS 2103001

Fits: CL.1, CYO

| | | |
|--|-------------------------------------|---------------|
|  | Chrome | 20 000 741-00 |
|  | Brushed Platinum | 20 000 741-06 |
|  | Dark Chrome | 20 000 741-19 |
|  | Brushed Durabronze (23kt Gold) | 20 000 741-28 |
|  | Matte Black | 20 000 741-33 |
|  | Brushed Champagne (22kt Gold) | 20 000 741-46 |
|  | Champagne (22kt Gold) | 20 000 741-47 |
|  | Brushed Dark Platinum | 20 000 741-99 |

20 000 741

mm [inches]

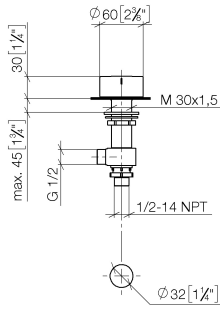

Flow rate chart



Codes & Standards

DIN 4109

ISO 3822

Scottish Water
Byelaws

UK Water Supply
Regulations

Ü-Zeichen



Deck valve anti-clockwise closing hot - Chrome

CL.1

20 000 741

Certificates

WRAS_2103

LGA_28

20 000 741

Product version from 4/1/2023

Parts for other finishes can be found here: Brushed Platinum

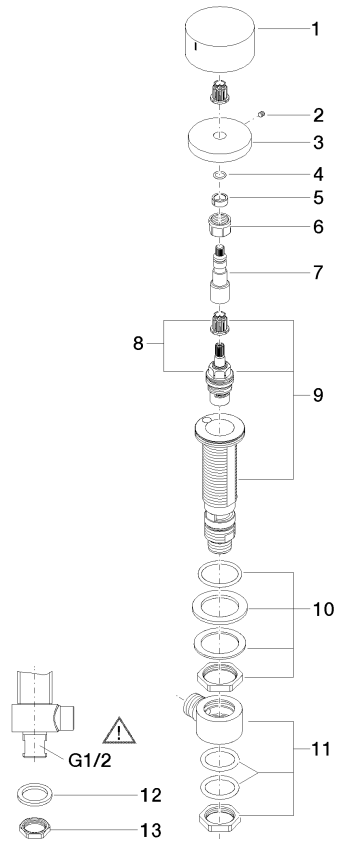



Deck valve anti-clockwise closing hot - Chrome

CL.1

20 000 741

Spare parts list

Product version from 4/1/2023

| No. | Item Number | Name | Quantity used | Delivery time |
|-----|-----------------|----------------|---------------|---------------|
| | 09 20 74 006-00 | handle (hot) | 13 | 10 |