

TARA Deck valve clockwise closing cold or hot - Brushed Champagne (22kt Gold)
TARA

20 000 892



- hole diameter 32 mm
- rosette Ø 55 mm
- WRAS

	Brushed Champagne (22kt Gold)	20 000 892-46
	Chrome	20 000 892-00
	Brushed Platinum	20 000 892-06
	Platinum	20 000 892-08
	Dark Chrome	20 000 892-19
	Brushed Durabronze (23kt Gold)	20 000 892-28
	Matte Black	20 000 892-33
	Brushed Bronze	20 000 892-42
	Champagne (22kt Gold)	20 000 892-47
	Brushed Chrome	20 000 892-93
	Brushed Dark Platinum	20 000 892-99

TARA Deck valve clockwise closing cold or hot - Brushed Champagne (22kt Gold)

TARA

20 000 892
mm [inches]

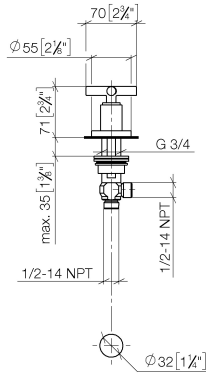

Flow rate chart

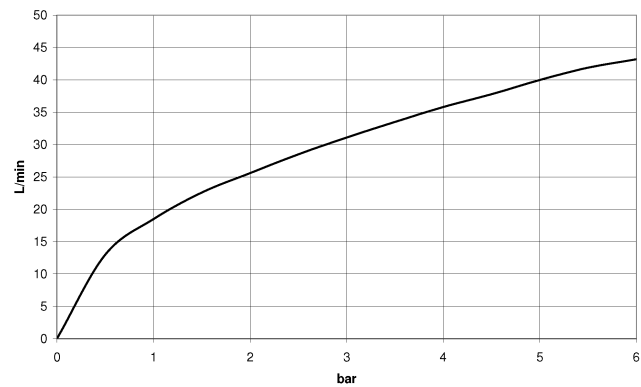

Codes & Standards

ASME A112.18.1	cUPC	Scottish Water Byelaws	UK Water Supply Regulations
----------------	------	---------------------------	--------------------------------



TARA Deck valve clockwise closing cold or hot - Brushed Champagne (22kt Gold)

TARA

20 000 892

Certificates and sustainability

WRAS_2112

IAPMO_4976

This diagram illustrates the exploded view of a water filter assembly. The components are numbered as follows:

- 1**: The entire assembly, indicated by a bracket on the right.
- 2**: A four-way connector with four angled ports.
- 3**: A cylindrical housing or cap.
- 4**: A small O-ring or seal.
- 5**: A screw or bolt used for tightening.
- 6**: A cylindrical filter element or cartridge.
- 7**: A circular base or support ring.
- 8**: A thin, circular gasket or seal.
- 9**: A multi-part assembly including a central filter head, a mounting bracket, and a threaded inlet/outlet, indicated by a bracket on the right.

No.	Item Number	Name	Quantity used	Delivery time
7	09 27 89 105-46	rosette	1.00	60
3	90 12 12 007 00-46	base	1.00	30
9	90 17 11 040 31 90	side panel	1.00	2
6	09 21 02 140-46	sleeve	1.00	60
2	09 20 89 010-46	handle	1.00	30
5	90 30 30 075 00 90	screw	1.00	2
8	90 14 10 043 00 90	seal	1.00	2
1	90 20 89 010 10-46	handle	1.00	30
4	90 30 11 029 00 90	disc	1.00	2