

## Pop-up waste and overflow with electronic control - Stainless Steel

---

10 410 003



- 3½" electronic drain valve (TouchFlow)
- button integrated in overflow
- concealed overflow
- strainer insert

Only suitable for combining with polished high-grade steel kitchen sinks.

Socket adapter required for 2-pin EU to 3-pin UK plug

Pop-up waste and overflow with electronic control - Stainless Steel

10 410 003

mm [inches]

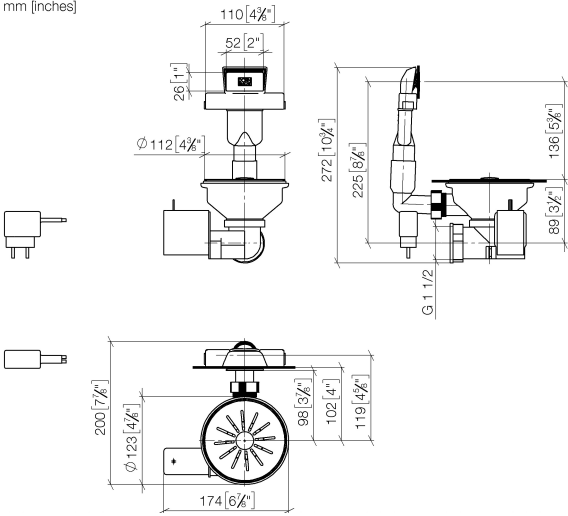

Pop-up waste and overflow with electronic control - Stainless Steel

10 410 003

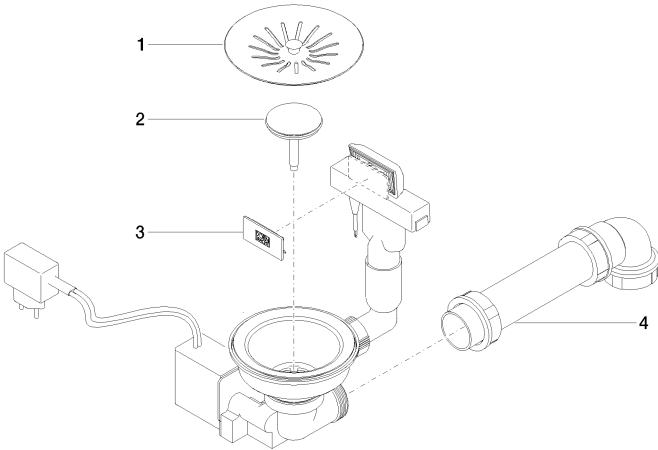

Spare parts list

| No. | Item Number        | Name   | Quantity used | Delivery time |
|-----|--------------------|--------|---------------|---------------|
| 1   | 90 11 01 201 06-85 | cover  | 1             | 60            |
| 2   | 90 11 01 201 01 90 | plug   | 1             | 60            |
| 3   | 90 11 01 202 00-85 | cover  | 1             | 60            |
| 4   | 90 11 01 201 02 90 | piping | 1             | 60            |