

MEM Three-hole basin mixer with pop-up waste - Brushed Bronze

MEM

20 705 782



- 165mm projection
- fixed spout
- rectangular, air-enriched flow
- height of mixer 144 mm
- height up to aerator 78 mm
- hole diameter spout 35 mm
- hole diameter valve 32 mm
- rosette 60 x 60 mm
- 2x screw-in M 10 x 1 pressure hose, leak-tested
- max. flow 5.7 l/min
- lead-free
- This product can help a building meet the requirements of Green Building Rating Systems, e.g. LEED®, BREEAM®, DGNB
- WRAS 240102004

Only suitable for basins with an overflow.

	Brushed Bronze	20 705 782-42
	Chrome	20 705 782-00
	Brushed Platinum	20 705 782-06
	Platinum	20 705 782-08
	Dark Chrome	20 705 782-19
	Brushed Durabronze (23kt Gold)	20 705 782-28
		20 705 782-39
		20 705 782-43
	Brushed Champagne (22kt Gold)	20 705 782-46
	Champagne (22kt Gold)	20 705 782-47
	Brushed Dark Platinum	20 705 782-99

MEM Three-hole basin mixer with pop-up waste - Brushed Bronze

MEM

20 705 782

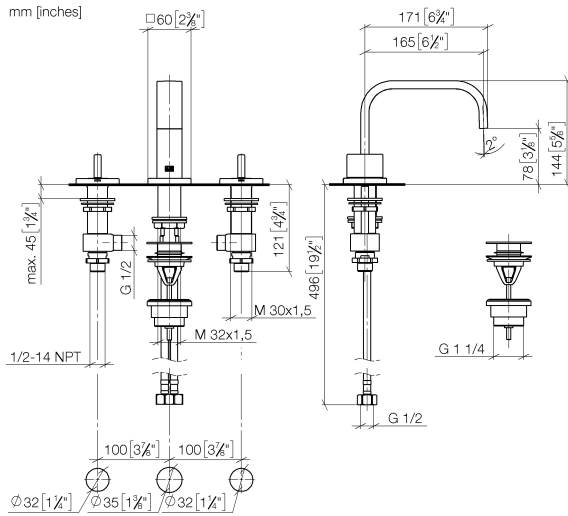

### Flow rate chart



## Codes & Standards

DIN 4109

Executive Order  
no. 1007

ISO 3822

Scottish Water  
Byelaws

## UK Water Supply Regulations

## Ü-Zeichen



## MEM Three-hole basin mixer with pop-up waste - Brushed Bronze

---

MEM

20 705 782

### Certificates

---

WRAS\_240102

LGA\_38

GDV\_0400

20 705 782

Parts for other  
finishes can be found  
here: [Chrome](#)

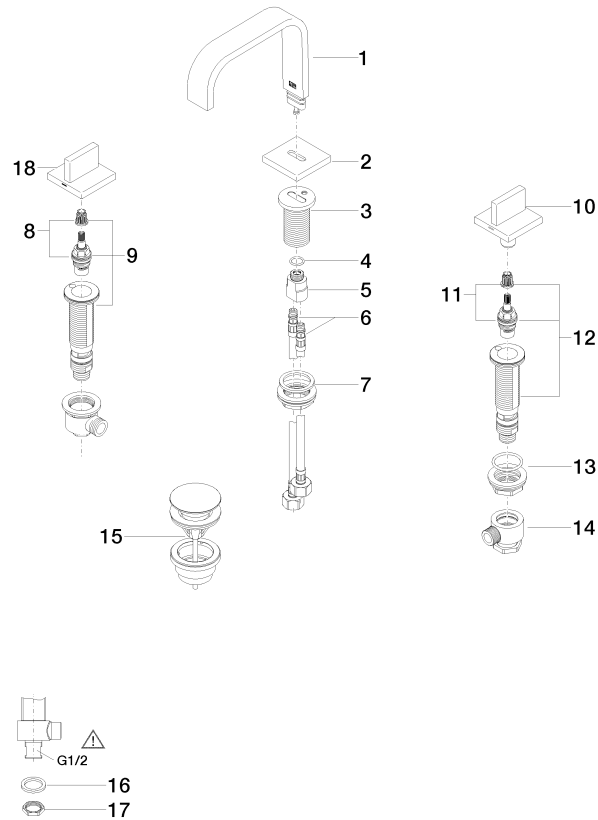



## MEM Three-hole basin mixer with pop-up waste - Brushed Bronze

---

MEM

20 705 782

### **Spare parts list**