

LULU Shower set without hand shower - Brushed Platinum

LULU

26 413 710



- slide bar
- rosette 78 x 55 mm
- gauge 800 mm
- metal shower hose 1750mm with integrated anti-twist protection
- shower hose connector 3/8"
- Pipe diameter 18 mm
- WRAS 2009048

This article does not include a hand shower!

	Brushed Platinum	26 413 710-06
	Chrome	26 413 710-00
	Platinum	26 413 710-08
	Brushed Durabronze (23kt Gold)	26 413 710-28
	Matte Black	26 413 710-33
	Brushed Dark Platinum	26 413 710-99

Recommended miscellaneous



- Concealed wall elbow -** 35 085 970 90
- max. recess depth 163 mm
 - min. recess depth 90 mm

Recommended miscellaneous



- LULU Wall elbow - Brushed Platinum** 28 450 710-06

Required miscellaneous



- Hand shower - Brushed Platinum** 28 012 979-06

Required miscellaneous



- Hand shower FlowReduce - Brushed Platinum** 28 016 979-06 0010

Required miscellaneous



- Hand shower - Brushed Platinum** 28 017 979-06

Required miscellaneous



- Hand shower FlowReduce - Brushed Platinum** 28 012 979-06 0010

Required miscellaneous



- Hand shower - Brushed Platinum** 28 016 979-06

Required miscellaneous



- Hand shower - Brushed Platinum** 28 018 979-06

Required miscellaneous



- Hand shower FlowReduce - Brushed Platinum** 28 018 979-06 0010

Required miscellaneous



- SERIES-VARIOUS Hand shower - Brushed Platinum** 28 029 979-06 0010

Required miscellaneous



- SERIES-VARIOUS Hand shower - Brushed Platinum** 28 029 979-06

Required miscellaneous



- SERIES-VARIOUS Hand shower - Brushed Platinum** 28 027 979-06 0010

Required miscellaneous



- SERIES-VARIOUS Hand shower - Brushed Platinum** 28 025 979-06 0010

LULU Shower set without hand shower - Brushed Platinum

LULU

26 413 710

mm [inches]

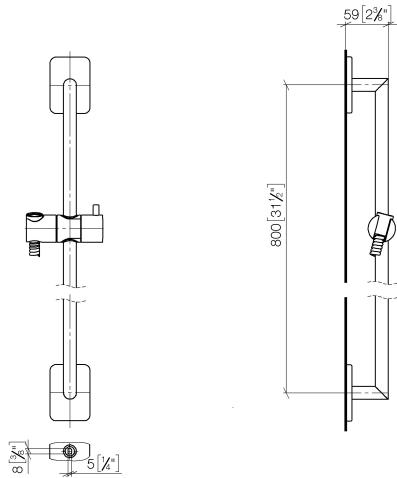

Codes & Standards

ASME A112.18.1	cUPC	Scottish Water Byelaws	UK Water Supply Regulations
XP P 41-280			

Certificates

IAPMO_4976	WRAS_2009	ACS_20 ACC LY
------------	-----------	---------------

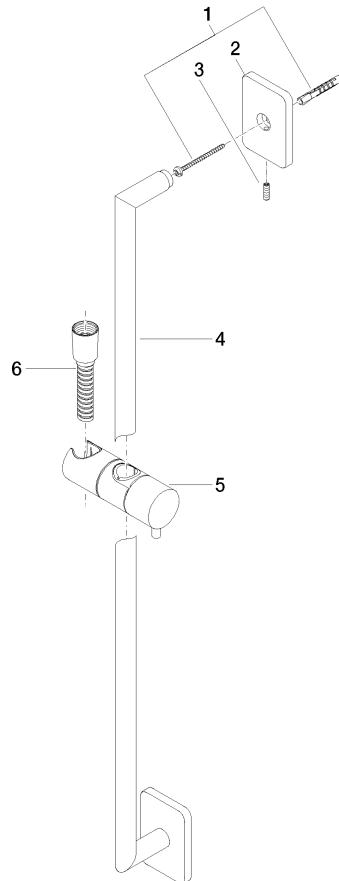



LULU Shower set without hand shower - Brushed Platinum

LULU

26 413 710

Spare parts list

No.	Item Number	Name	Quantity used	Delivery time
	05 30 31 025 00 90	fixing set	9	2