

VAIA Shower set without hand shower - Platinum

VAIA

26 413 809



- slide bar
- rosette Ø 60 mm
- gauge 800 mm
- metal shower hose 1700mm with integrated anti-twist protection
- shower hose connector 3/8"
- Pipe diameter 18 mm
- WRAS 2009048

This article does not include a hand shower!

	Platinum	26 413 809-08
	Chrome	26 413 809-00
	Brushed Platinum	26 413 809-06
	Dark Chrome	26 413 809-19
	Brushed Durabronze (23kt Gold)	26 413 809-28
	Brushed Bronze	26 413 809-42
	Brushed Champagne (22kt Gold)	26 413 809-46
	Champagne (22kt Gold)	26 413 809-47
	Brushed Dark Platinum	26 413 809-99

VAIA Shower set without hand shower - Platinum

VAIA

26 413 809

Recommended miscellaneous



Concealed wall elbow -
 • max. recess depth 163 mm
 • min. recess depth 90 mm

35 085 970 90

Required miscellaneous



Hand shower - Platinum

28 012 979-08

Required miscellaneous



Hand shower FlowReduce - Platinum

28 012 979-08 0010

Recommended miscellaneous



VAIA Wall elbow - Platinum

28 450 809-08

Required miscellaneous



Hand shower - Platinum

28 018 979-08

Required miscellaneous



SERIES-VARIOUS Hand shower - Platinum

28 029 979-08

Required miscellaneous



SERIES-VARIOUS Hand shower - Platinum

28 025 979-08 0010

Required miscellaneous



Hand shower - Platinum

28 016 979-08

Required miscellaneous



Hand shower FlowReduce - Platinum

28 016 979-08 0010

Required miscellaneous



Hand shower - Platinum

28 017 979-08

Recommended miscellaneous



VAIA Wall elbow - Platinum

28 450 809-08

Required miscellaneous



Hand shower FlowReduce - Platinum

28 018 979-08 0010

Required miscellaneous



SERIES-VARIOUS Hand shower - Platinum

28 027 979-08 0010

VAIA Shower set without hand shower - Platinum

VAIA

26 413 809

mm [inches]

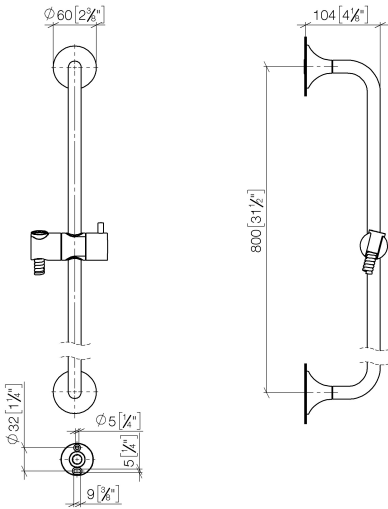

Codes & Standards

ASME A112.18.1	cUPC	Scottish Water Byelaws	UK Water Supply Regulations
XP P 41-280			

Certificates

IAPMO_4976	WRAS_2009	ACS_20 ACC LY
------------	-----------	---------------

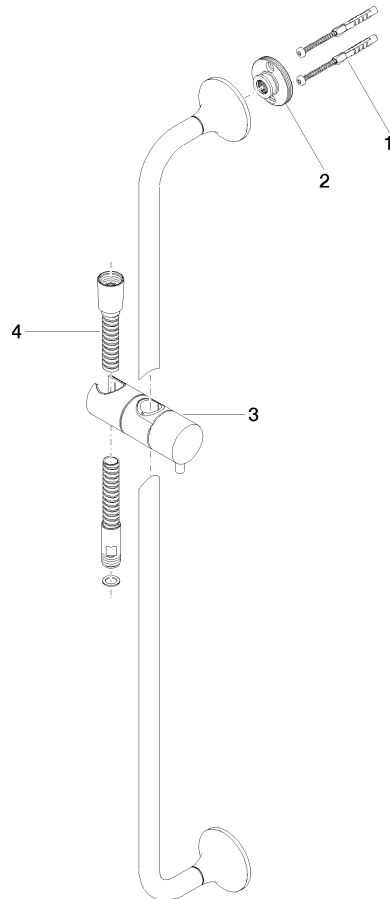



VAIA Shower set without hand shower - Platinum

VAIA

26 413 809

Spare parts list

No.	Item Number	Name	Quantity used	Delivery time
	05 30 31 025 00 90	fixing set	6	2