

MADISON Hand shower FlowReduce - Brushed Dark Platinum

MADISON

28 002 978



- Three settings: COMPACT RAIN, COMPACT SOFT FLOW, COMPACT AQUAPRESSURE FLOW, max. flow rate 6.8 l/min (at 3 bar)
- with anti-scale system
- spray head Ø 95mm
- 1/2" connection
- This product can help a building meet the requirements of Green Building Rating Systems, e.g. LEED®, BREEAM®, DGNB

Intrinsic protection against back flow.

| | | |
|--|-------------------------------|--------------------|
|  | Brushed Dark Platinum | 28 002 978-99 0010 |
|  | Chrome | 28 002 978-00 |
|  | Chrome | 28 002 978-00 0010 |
|  | Brushed Platinum | 28 002 978-06 |
|  | Brushed Platinum | 28 002 978-06 0010 |
|  | Platinum | 28 002 978-08 |
|  | Platinum | 28 002 978-08 0010 |
|  | Durabrand (23kt Gold) | 28 002 978-09 |
|  | Durabrand (23kt Gold) | 28 002 978-09 0010 |
|  | Brushed Durabrand (23kt Gold) | 28 002 978-28 |
|  | Brushed Durabrand (23kt Gold) | 28 002 978-28 0010 |
|  | Brushed Chrome | 28 002 978-93 |
|  | Brushed Chrome | 28 002 978-93 0010 |
|  | Brushed Dark Platinum | 28 002 978-99 |

28 002 978

mm [inches]

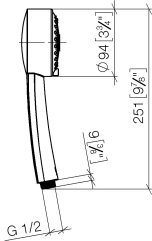

Flow rate chart

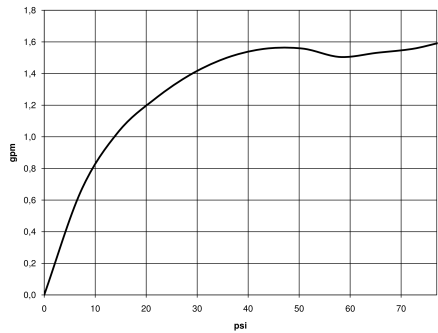

Codes & Standards

| | | | |
|----------------|-----------|------------|---|
| ASME A112.18.1 | cUPC | DIN 4109 | EPA WaterSense |
| ISO 3822 | Ü-Zeichen | WaterSense |  |



MADISON Hand shower FlowReduce - Brushed Dark Platinum

MADISON

28 002 978

Certificates

IAPMO_4976

LGA_18

IAPMO_11

Parts for other
finishes can be found
here: [Chrome](#)

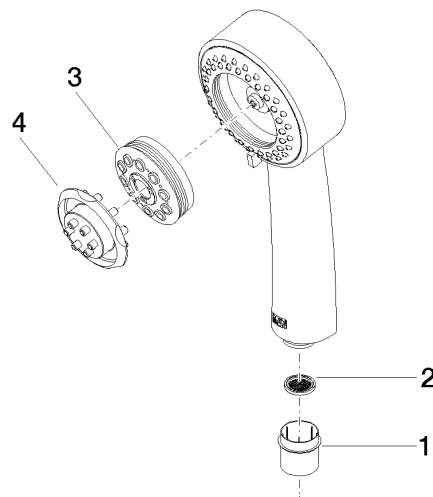



MADISON Hand shower FlowReduce - Brushed Dark Platinum

MADISON

28 002 978

Spare parts list

| No. | Item Number | Name | Quantity used | Delivery time |
|-----|-----------------|------|---------------|---------------|
| | 09 21 02 115 90 | cap | 4 | 2 |