







# IMO Single-lever basin mixer with high spout without pop-up waste - Matte Black

33 526 671    Product version from 4/1/2024



- 165mm projection
- fixed spout
- rectangular, air-enriched flow
- height of mixer 278 mm
- height up to aerator 235 mm
- hole diameter 35 mm
- 2x screw-in M 8 x 1 pressure hose, leak-tested
- max. flow 4.6 l/min
- lead-free
- This product can help a building meet the requirements of Green Building Rating Systems, e.g. LEED®, BREEAM®, DGNB

|   |                       |               |
|---|-----------------------|---------------|
|  | Matte Black           | 33 526 671-33 |
|  | Chrome                | 33 526 671-00 |
|  | Brushed Platinum      | 33 526 671-06 |
|  | Dark Chrome           | 33 526 671-19 |
|  | Brushed Light Gold    | 33 526 671-27 |
|  | Brushed Chrome        | 33 526 671-93 |
|  | Brushed Dark Platinum | 33 526 671-99 |

**IMO Single-lever basin mixer with high spout without pop-up waste - Matte Black**

33 526 671 Product version from 4/1/2024

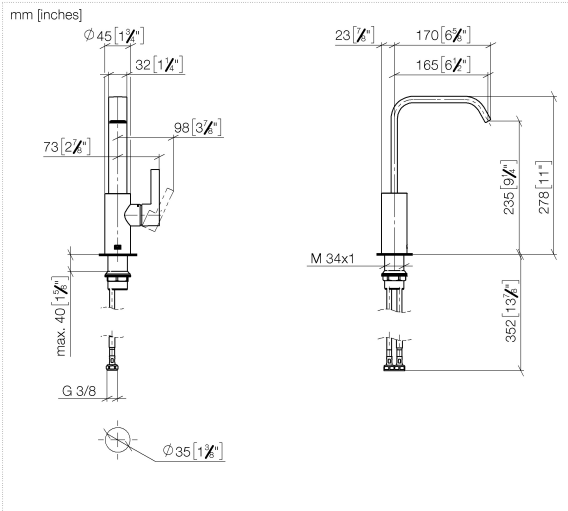

Flow rate chart

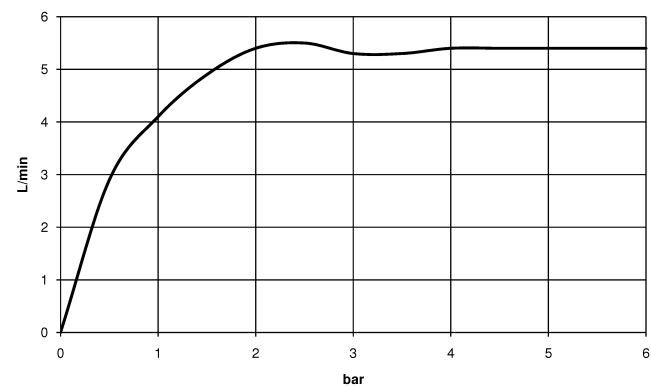

**Codes & Standards**

DIN 4109

ISO 3822

Ü-Zeichen



## IMO Single-lever basin mixer with high spout without pop-up waste - Matte Black

---

33 526 671 Product version from 4/1/2024

### Certificates

---

LGA\_28

## IMO Single-lever basin mixer with high spout without pop-up waste - Matte Black

33 526 671 Product version from 4/1/2024

Parts for other  
finishes can be found  
here: [Chrome](#)

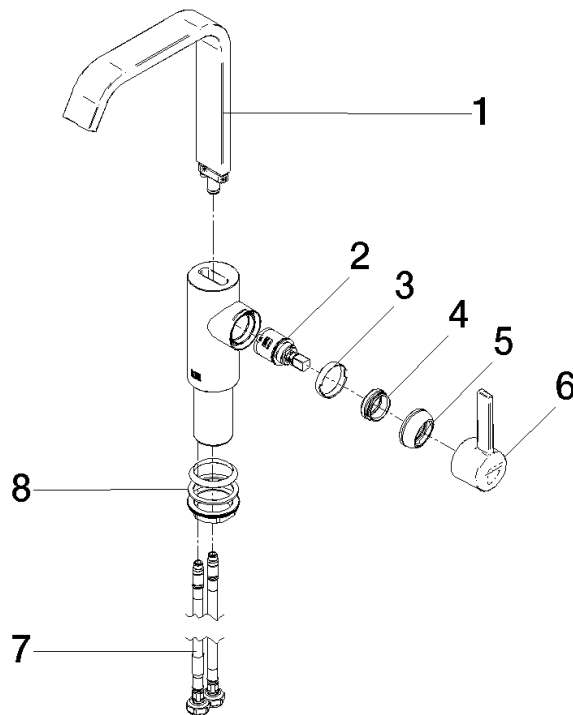

### Spare parts list

| No.  | Item Number        | Name       | Quantity used | Delivery time |
|--|--------------------|------------|---------------|---------------|
| 1  | 90 28 22 404 00-33 | spout      | 1             | -             |
| Spare part can no longer be ordered, please order the replacement item |                    |            |               |               |
| 2  | 90 15 05 042 00 90 | cartridge  | 1             | 2             |
| 3  | 90 23 10 128 00 90 | nut        | 1             | 2             |
| 4  | 09 24 04 266 90    | nut        | 1             | 2             |
| 5  | 90 28 30 061 00-33 | cover      | 1             | -             |
| Spare part can no longer be ordered, please order the replacement item |                    |            |               |               |
| 6  | 90 20 67 027 00-33 | handle     | 1             | 30            |
| 7  | 04 30 04 100 00 90 | hose       | 2             | 2             |
| 8  | 04 23 10 044 07 90 | fixing set | 1             | 2             |