





**CYO Wall-mounted single-lever basin mixer without pop-up waste - Brushed
Durabrass (23kt Gold)**

CYO

36 860 811



- 160mm projection
- fixed spout
- rectangular, air-enriched flow
- hole diameter spout 37 mm
- hole diameter single-lever mixer 57 mm
- rosette for mixer 80 x 80mm
- max. flow 4.5 l/min
- lead-free
- This product can help a building meet the requirements of Green Building Rating Systems, e.g. LEED®, BREEAM®, DGNB
- WRAS 2107047

| | | |
|--|-------------------------------------|---------------|
|  | Brushed Durabrass (23kt Gold) | 36 860 811-28 |
|  | Chrome | 36 860 811-00 |
|  | Brushed Platinum | 36 860 811-06 |
|  | Dark Chrome | 36 860 811-19 |
|  | Brushed Dark Platinum | 36 860 811-99 |

Required miscellaneous



- Concealed wall-mounted single-lever mixer -** 35 860 970 90
- max. recess depth 95 mm
 - min. recess depth 80 mm

CYO Wall-mounted single-lever basin mixer without pop-up waste - Brushed Durabron (23kt Gold)

CYO

36 860 811
mm [inches]

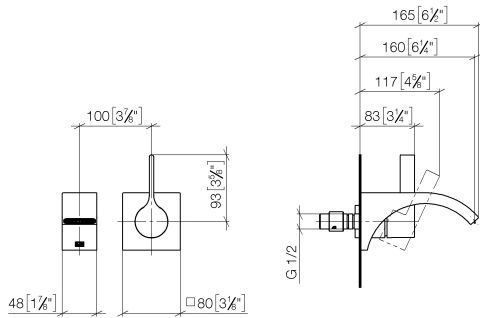

Flow rate chart



Codes & Standards

DIN 4109

ISO 3822

NSF372

NSF61

Scottish Water
Byelaws

UK Water Supply
Regulations

Ü-Zeichen



CYO Wall-mounted single-lever basin mixer without pop-up waste - Brushed
Durabross (23kt Gold)

CYO

36 860 811
Certificates

| | | | |
|--------|-----------|------------|--------------|
| LGA_38 | WRAS_2107 | IAPMO_6397 | IAPMO_N-4976 |
|--------|-----------|------------|--------------|

**CYO Wall-mounted single-lever basin mixer without pop-up waste - Brushed
Durabronz (23kt Gold)**

CYO

36 860 811





CYO Wall-mounted single-lever basin mixer without pop-up waste - Brushed
Durabrass (23kt Gold)

CYO

36 860 811

Spare parts list

| No. | Item Number | Name | Quantity used | Delivery time |
|-----|---------------|--|---------------|---------------|
| | 13 800 811-28 | CYO Wall-mounted basin spout without pop-up waste - Brushed Durabrass (23kt Gold) | 10 | 20 |