

# TARA Bath grip - Platinum

TARA

83 030 892    Product version from 4/1/2024



- gauge 300 mm
- width 355mm
- height 55 mm
- rosette Ø 55 mm
- 80mm projection

	Platinum	83 030 892-08
	Chrome	83 030 892-00
	Brushed Platinum	83 030 892-06
	Dark Chrome	83 030 892-19
	Brushed Durabrass (23kt Gold)	83 030 892-28
	Matte Black	83 030 892-33
	Brushed Dark Brass	83 030 892-39
	Brushed Bronze	83 030 892-42
	Brushed Champagne (22kt Gold)	83 030 892-46
	Champagne (22kt Gold)	83 030 892-47
	Brushed Chrome	83 030 892-93
	Brushed Dark Platinum	83 030 892-99

mm [inches]



## Codes & Standards

TÜV-Zeichen

## Certificates and sustainability

TÜV\_B0358530023 TÜV\_B0358530023

Parts for other  
finishes can be found  
here: [Chrome](#)

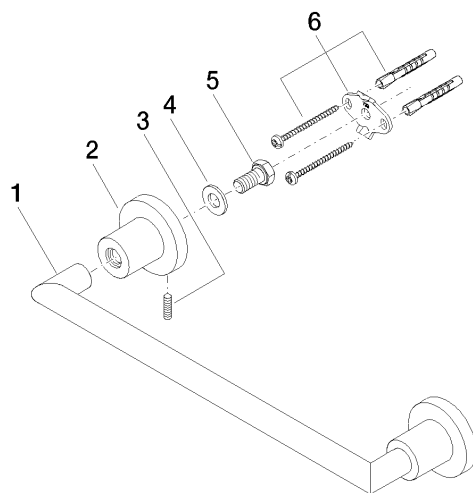

## Spare parts list

No.	Item Number	Name	Quantity used	Delivery time
2	08 17 89 505-08	holder	2.00	40
1	05 28 22 587 00-08	holder	1.00	40
4	09 30 11 046 90	disc	2.00	2
3	04 31 11 113 00 90	pin	2.00	2
6	05 17 20 739 00 90	fixing set	2.00	2
5	09 30 30 071 90	screw	2.00	2