

TARA Single-hole basin mixer with pop-up waste - Brushed Champagne (22kt Gold)

TARA

22 513 892 Product version from 5/27/2021



- 165mm projection
- pivotable spout 360°
- circular, air-enriched flow
- height of mixer 295 mm
- height up to aerator 172 mm
- hole diameter 35 mm
- rosette Ø 59 mm
- 2x screw-in M 10 x 1 pressure hose, leak-tested
- max. flow 7 l/min
- lead-free
- This product can help a building meet the requirements of Green Building Rating Systems, e.g. LEED®, BREEAM®, DGNB
- WRAS

Only suitable for basins with an overflow.

| | | |
|---|--------------------------------|---------------|
|  | Brushed Champagne (22kt Gold) | 22 513 892-46 |
|  | Chrome | 22 513 892-00 |
|  | Brushed Platinum | 22 513 892-06 |
|  | Platinum | 22 513 892-08 |
|  | Dark Chrome | 22 513 892-19 |
|  | Brushed Durabronze (23kt Gold) | 22 513 892-28 |
|  | Matte Black | 22 513 892-33 |
|  | Brushed Dark Brass | 22 513 892-39 |
|  | Brushed Bronze | 22 513 892-42 |
|  | Champagne (22kt Gold) | 22 513 892-47 |
|  | Brushed Chrome | 22 513 892-93 |
|  | Brushed Dark Platinum | 22 513 892-99 |

TARA Single-hole basin mixer with pop-up waste - Brushed Champagne (22kt Gold)

TARA

22 513 892 Product version from 5/27/2021
mm [inches]

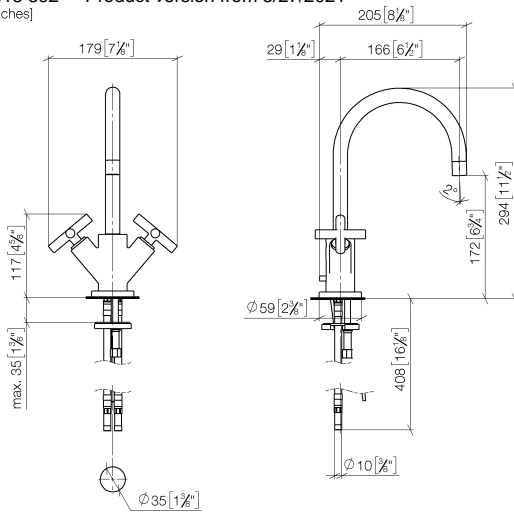

Flow rate chart



Codes & Standards

| | | | |
|---------------------------|--------------------------------|-----------------------------|------------|
| DIN 4109 | EN 200 | Executive Order no. 1007 | ISO 3822 |
| Scottish Water Byelaws | UK Water Supply Regulations | Ü-Zeichen | VA-Zeichen |



TARA Single-hole basin mixer with pop-up waste - Brushed Champagne (22kt Gold)

TARA

22 513 892 Product version from 5/27/2021

Certificates and sustainability

| | | | |
|--------|--------|----------|-------------|
| ETA_18 | LGA_18 | GDV_0400 | WRAS_240702 |
|--------|--------|----------|-------------|

TARA Single-hole basin mixer with pop-up waste - Brushed Champagne (22kt Gold)

TARA

22 513 892 Product version from 5/27/2021

Parts for other
finishes can be found
here: [Chrome](#)

