

Hand shower set with individual rosettes with volume control FlowReduce - Champagne (22kt Gold)

SERIES SPECIFIC

27 809 985



- COMPACT RAIN, max. flow rate 6.8 l/min (at 3 bar)
- with volume control
- metal shower hose 1250mm with integrated anti-twist protection
- 3/8" shower outlet
- with anti-scale system

Technical data:

- rosette for wall elbow 60 x 60mm
- rosette for shower holder 60 x 60mm
- 1/2" wall elbow

Notes:

- WRAS

Intrinsic protection against back flow.

	Champagne (22kt Gold)	27 809 985-47 0010
	Chrome	27 809 985-00
	Chrome	27 809 985-00 0010
	Brushed Platinum	27 809 985-06
	Brushed Platinum	27 809 985-06 0010
	Platinum	27 809 985-08 0010
	Platinum	27 809 985-08
	Dark Chrome	27 809 985-19 0010
	Brushed Durabrass (23kt Gold)	27 809 985-28
	Brushed Durabrass (23kt Gold)	27 809 985-28 0010
	Brushed Dark Brass	27 809 985-39 0010
	Brushed Bronze	27 809 985-42 0010
	Brushed Champagne (22kt Gold)	27 809 985-46
	Brushed Champagne (22kt Gold)	27 809 985-46 0010
	Champagne (22kt Gold)	27 809 985-47
	Brushed Chrome	27 809 985-93 0010
	Brushed Chrome	27 809 985-93
	Brushed Dark Platinum	27 809 985-99 0010
	Brushed Dark Platinum	27 809 985-99



Hand shower set with individual rosettes with volume control FlowReduce -
Champagne (22kt Gold)

SERIES SPECIFIC

27 809 985
mm [inches]

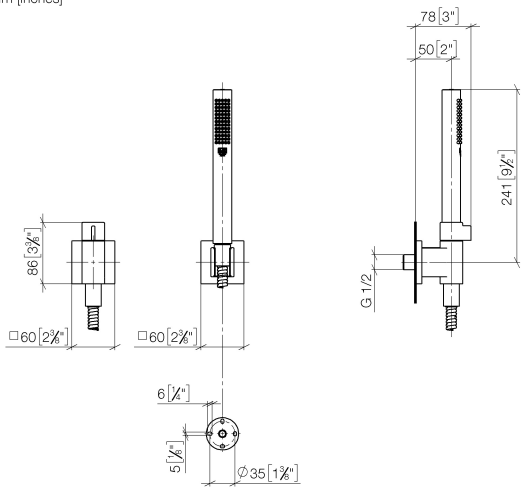

Codes & Standards

ASME A112.18.1	cUPC	DIN 4109	ISO 3822
----------------	------	----------	----------

Ü-Zeichen

Certificates and sustainability

LGA_29 IAPMO_4976 (

Hand shower set with individual rosettes with volume control FlowReduce - Champagne (22kt Gold)

SERIES SPECIFIC

27 809 985
Parts for other
finishes can be found
here: [Chrome](#)

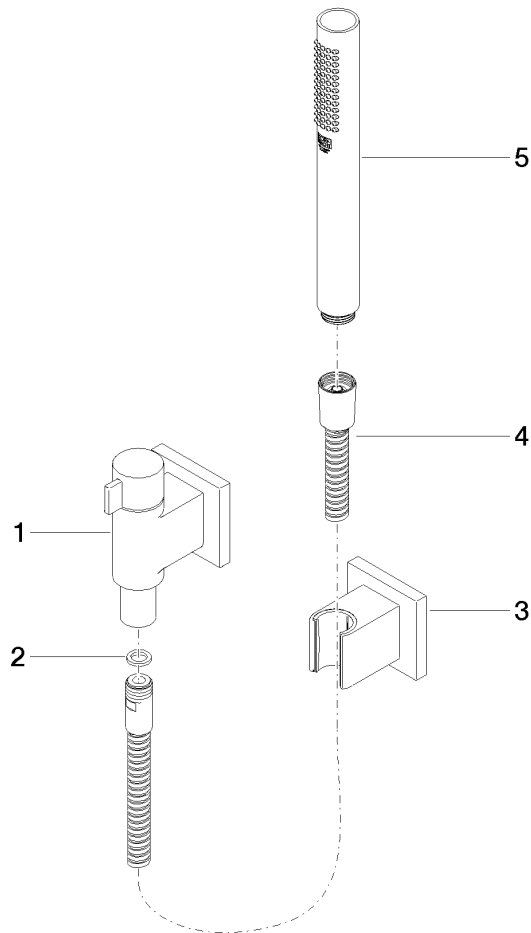

Spare parts list

No.	Item Number	Name	Quantity used	Delivery time
1	28 451 985-47	connection	1.00	-
Spare part can no longer be ordered, please order the replacement item				
4	90 30 02 072 00-47	Metal shower hose 1/2" x 3/8" x 1250 mm - Champagne (22kt Gold)	1.00	30
3	28 050 980-47	Wall bracket - Champagne (22kt Gold)	1.00	30
2	90 14 20 026 00 90	seal	1.00	2
5	90 12 11 140 41-47	shower	1.00	30