

MADISON Rain shower with wall fixing 200 mm - Platinum

MADISON

28 545 977



Product version up to 12/5/2019



- rain shower Ø 200 mm
- PURE RAIN, max. flow rate 14 l/min (at 3 bar)
- Function from: 8 l/min
- with anti-scale system

Technical data:

- 435mm projection
- rosette Ø 55 mm
- 1/2" connection

| | | |
|---|-------------------------------|---------------|
|  | Platinum | 28 545 977-08 |
|  | Chrome | 28 545 977-00 |
|  | Brushed Platinum | 28 545 977-06 |
|  | Durabrand (23kt Gold) | 28 545 977-09 |
|  | Brushed Durabrand (23kt Gold) | 28 545 977-28 |
|  | Brushed Dark Brass | 28 545 977-39 |
|  | Brushed Chrome | 28 545 977-93 |
|  | Brushed Dark Platinum | 28 545 977-99 |

Recommended miscellaneous



- Concealed wall elbow -

•min. recess depth 90 mm

•max. recess depth 163 mm

35 085 970 90

28 545 977 Product version up to 12/5/2019



Flow rate chart



Codes & Standards

DIN 4109

EN 1112

ISO 3822

Scottish Water
Byelaws

UK Water Supply
Regulations

Ü-Zeichen



MADISON Rain shower with wall fixing 200 mm - Platinum

MADISON

28 545 977 Product version up to 12/5/2019

Certificates and sustainability

| | | |
|---------------------|--------|-------------|
| DVGW_DW- 6517DN0 | LGA_38 | WRAS_250102 |
|---------------------|--------|-------------|

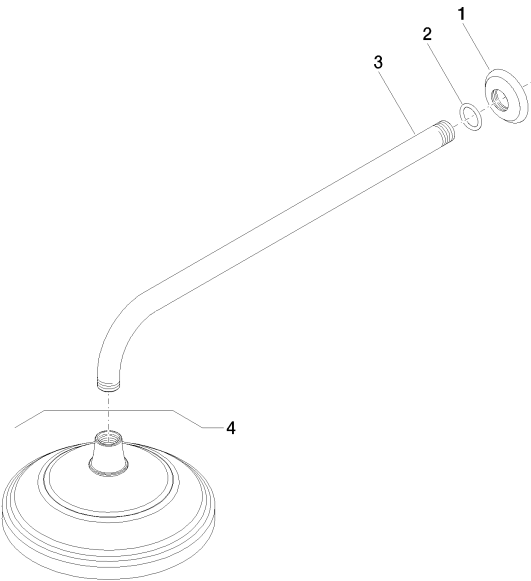

Spare parts list

| No. | Item Number | Name | Quantity used | Delivery time |
|-----|--------------------|------------|---------------|---------------|
| 1 | 09 27 35 003-08 | rosette | 1.00 | 40 |
| 3 | 09 11 03 017-08 | connection | 1.00 | 40 |
| 2 | 90 14 10 026 00 90 | seal | 1.00 | 2 |