

## META Bath spout without diverter for free-standing assembly - Brushed Dark Platinum

13 672 661 Product version from 5/27/2021



- 282mm projection
- circular normal flow
- total height 811 - 881 mm
- height up to aerator 671 – 741 mm
- slide-on rosettes Ø 135 mm
- max. flow 28.6 l/min at 3 bar flow pressure
- WRAS

|   |                               |               |
|---|-------------------------------|---------------|
|    | Brushed Dark Platinum         | 13 672 661-99 |
|    | Chrome                        | 13 672 661-00 |
|    | Brushed Platinum              | 13 672 661-06 |
|    | Dark Chrome                   | 13 672 661-19 |
|    | Light Gold                    | 13 672 661-26 |
|    | Brushed Light Gold            | 13 672 661-27 |
|    | Matte Black                   | 13 672 661-33 |
|    | Brushed Bronze                | 13 672 661-42 |
|    | Brushed Champagne (22kt Gold) | 13 672 661-46 |
|   | Champagne (22kt Gold)         | 13 672 661-47 |
|  | Brushed Chrome                | 13 672 661-93 |

### Required miscellaneous



#### Concealed floor mounting -

35 945 970 90

- min. recess depth mm
- max. recess depth mm

**META Bath spout without diverter for free-standing assembly - Brushed Dark Platinum**

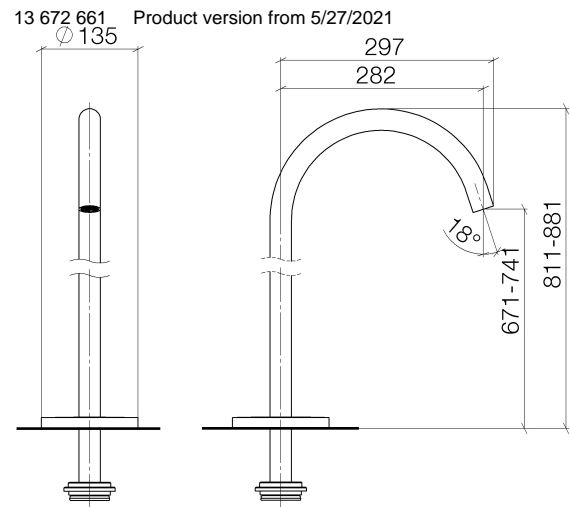

**Flow rate chart**

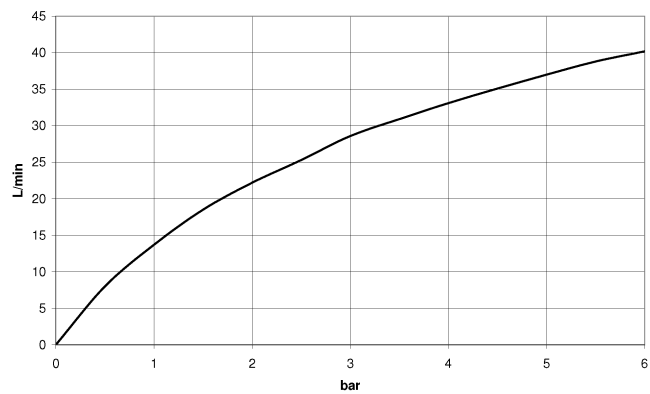

**Codes & Standards**

DIN 4109      ISO 3822      Ü-Zeichen



## META Bath spout without diverter for free-standing assembly - Brushed Dark Platinum

---

13 672 661 Product version from 5/27/2021

### Certificates

---

LGA\_18

**META Bath spout without diverter for free-standing assembly - Brushed Dark Platinum**

13 672 661 Product version from 5/27/2021

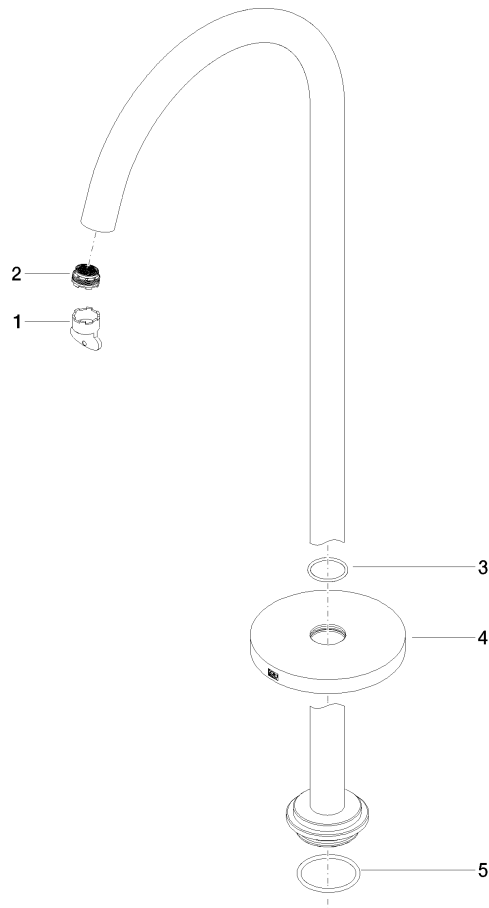

**Spare parts list**

| No. | Item Number        | Name    | Quantity used | Delivery time |
|-----|--------------------|---------|---------------|---------------|
| 1   | 04 30 09 027 00 90 | key     | 1             | 2             |
| 2   | 09 29 03 127 90    | aerator | 1             | 60            |
| 3   | 09 14 10 101 90    | seal    | 1             | 2             |
| 4   | 09 27 85 003-99    | rosette | 1             | 60            |
| 5   | 09 14 10 084 90    | seal    | 1             | 2             |