



- 146mm projection
- pivotable spout 360°
- laminar flow
- height of mixer 289 mm
- height up to laminar flow regulator 180 mm
- hole diameter 35 mm
- provides filtered, hot water up to 93°C
- Provides filtered water
- max. flow 3.8 l/min at 3 bar flow pressure
- mechanical valve
- lead-free
- lever

• This product can help a building meet the requirements of Green Building Rating Systems, e.g. LEED®, BREEAM®, DGNB

**A minimum flow pressure of 3 bar is necessary for the HOT & COLD WATER DISPENSER to work perfectly in conjunction with a hot water tank and filter.**

**The installation must be above a kitchen sink.**

**The filter cartridge must be changed every six months. The installation instructions contain further information for guidance.**

**Detailed planning information and technical data can be found at**

**[www.dornbracht.com/professional](http://www.dornbracht.com/professional)**

**Not compatible with reverse osmosis filtration**

A minimum flow pressure of 3 bar is necessary for the HOT & COLD WATER DISPENSER to work perfectly in conjunction with a hot water tank and filter.

The installation must be above a kitchen sink.

The filter cartridge must be changed every six months. The installation instructions contain further information for guidance.

Detailed planning information and technical data can be found at [www.dornbracht.com/professional](http://www.dornbracht.com/professional)

Not compatible with reverse osmosis filtration

|   |                                |               |
|---|--------------------------------|---------------|
|    | Brushed Bronze                 | 17 871 875-42 |
|    | Chrome                         | 17 871 875-00 |
|    | Brushed Platinum               | 17 871 875-06 |
|    | Platinum                       | 17 871 875-08 |
|    | Durabronze (23kt Gold)         | 17 871 875-09 |
|    | Dark Chrome                    | 17 871 875-19 |
|    | Brushed Durabronze (23kt Gold) | 17 871 875-28 |
|    | Matte Black                    | 17 871 875-33 |
|    | Brushed Champagne (22kt Gold)  | 17 871 875-46 |
|   | Champagne (22kt Gold)          | 17 871 875-47 |
|  | Brushed Chrome                 | 17 871 875-93 |
|  | Brushed Dark Platinum          | 17 871 875-99 |

## Required miscellaneous



**Hot water tank incl. filter -**

**12 892 970 90**

## Required miscellaneous



**Hose set**

**12 530 970 90**

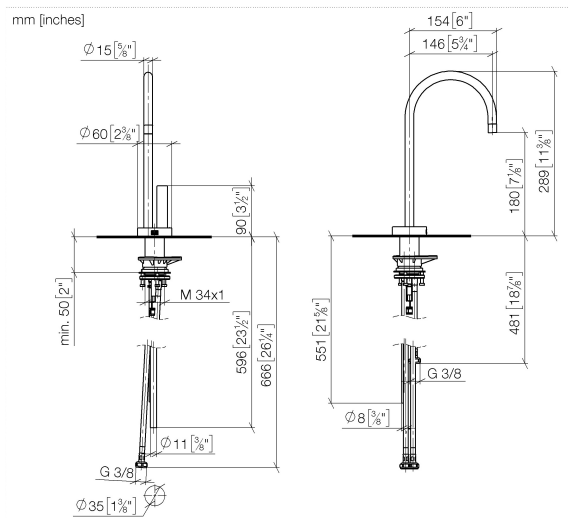



### Spare parts list

| No. | Item Number        | Name  | Quantity used | Delivery time |
|-----|--------------------|-------|---------------|---------------|
| 1   | 90 17 87 187 50-42 | spout | 1.00          | 30            |
| 2   | 90 17 87 179 01 90 | set   | 1.00          | 2             |