

## Hand shower set with individual rosettes with volume control - Platinum

SERIES SPECIFIC

27 809 985 Product version up to 6/3/2020



- COMPACT RAIN, max. flow rate 15 l/min (at 3 bar)
- with volume control
- metal shower hose 1250mm with integrated anti-twist protection
- 3/8" shower outlet
- with anti-scale system

### Technical data:

- rosette for wall elbow 60 x 60mm
- rosette for shower holder 60 x 60mm
- 1/2" wall elbow

### Notes:

- WRAS

Intrinsic protection against back flow.

	Platinum	27 809 985-08
	Chrome	27 809 985-00
	Chrome	27 809 985-00 0010
	Brushed Platinum	27 809 985-06
	Brushed Platinum	27 809 985-06 0010
	Platinum	27 809 985-08 0010
	Dark Chrome	27 809 985-19 0010
	Brushed Durabronze (23kt Gold)	27 809 985-28
	Brushed Durabronze (23kt Gold)	27 809 985-28 0010
	Brushed Dark Brass	27 809 985-39 0010
	Brushed Bronze	27 809 985-42 0010
	Brushed Champagne (22kt Gold)	27 809 985-46
	Brushed Champagne (22kt Gold)	27 809 985-46 0010
	Champagne (22kt Gold)	27 809 985-47
	Champagne (22kt Gold)	27 809 985-47 0010
	Brushed Chrome	27 809 985-93 0010
	Brushed Chrome	27 809 985-93
	Brushed Dark Platinum	27 809 985-99
	Brushed Dark Platinum	27 809 985-99 0010

## Recommended miscellaneous

### Concealed wall elbow -

35 085 970 90



- max. recess depth 163 mm
- min. recess depth 90 mm

27 809 985 Product version up to 6/3/2020

mm [inches]

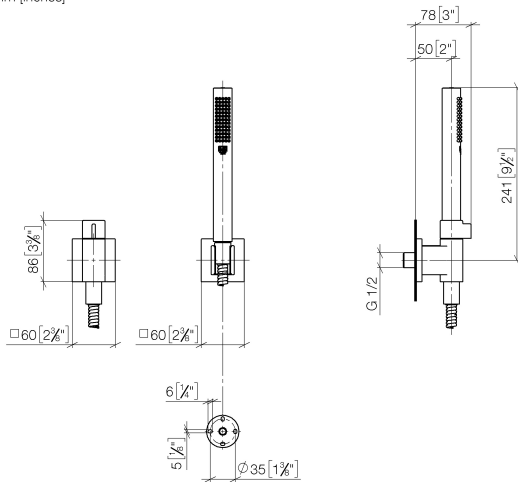

Flow rate chart



### Codes & Standards

DIN 4109

EN 1717

ISO 3822

Scottish Water  
Byelaws

UK Water Supply  
Regulations

Ü-Zeichen



## Hand shower set with individual rosettes with volume control - Platinum

SERIES SPECIFIC

27 809 985 Product version up to 6/3/2020

### Certificates and sustainability

Belgaqua\_21-024-2 WRAS\_2207

LGA\_29

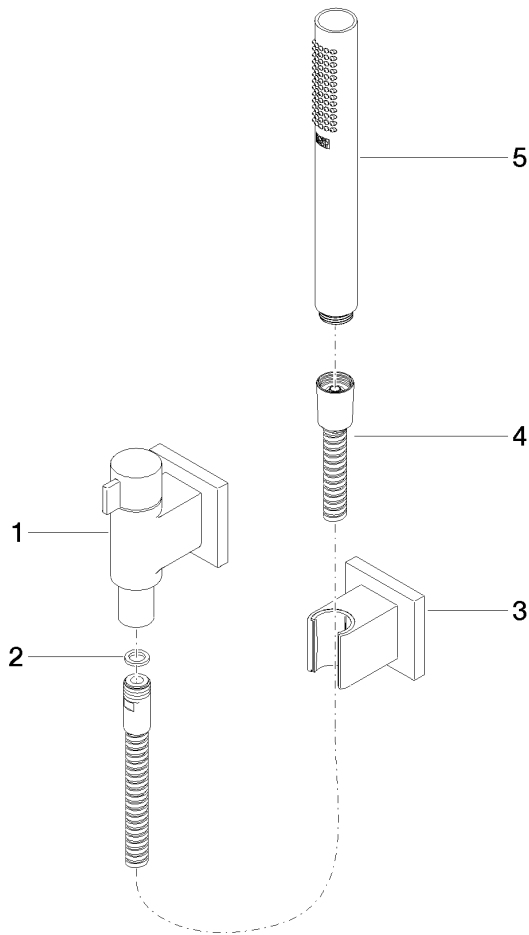

### Spare parts list

No.	Item Number	Name	Quantity used	Delivery time
4	90 30 02 072 00-08	Metal shower hose 1/2" x 3/8" x 1250 mm - Platinum	1.00	40
1	28 451 985-08	connection	1.00	60
3	28 050 980-08	Wall bracket - Platinum	1.00	40
2	90 14 20 026 00 90	seal	1.00	2
5	90 12 11 140 40-08	shower	1.00	40