

## Affusion pipe with cover plate - Brushed Durabrand (23kt Gold)

27 838 979 Product version from 3/2/2021



- LAMINAR FLOW, max. flow rate 15 l/min (at 3 bar)
- 3/8" shower outlet
- cover plate 240 x 60 mm
- metal shower hose 1250mm with integrated anti-twist protection
- 1/2" connection
- plug-link mounting

Intrinsic protection against back flow.

|   |                               |               |
|---|-------------------------------|---------------|
|  | Brushed Durabrand (23kt Gold) | 27 838 979-28 |
|  | Chrome                        | 27 838 979-00 |
|  | Brushed Platinum              | 27 838 979-06 |
|  | Platinum                      | 27 838 979-08 |
|  | Dark Chrome                   | 27 838 979-19 |
|  | Brushed Light Gold            | 27 838 979-27 |
|  | Matte Black                   | 27 838 979-33 |
|  | Brushed Chrome                | 27 838 979-93 |
|  | Brushed Dark Platinum         | 27 838 979-99 |

### Recommended miscellaneous



- Concealed wall elbow -**
- max. recess depth mm
  - min. recess depth mm

35 085 970 90

# Affusion pipe with cover plate - Brushed Durabron (23kt Gold)

27 838 979    Product version from 3/2/2021

mm [inches]

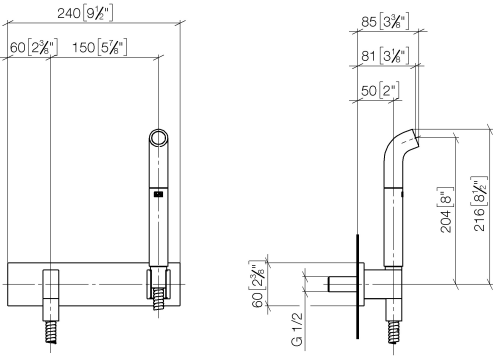

Flow rate chart



## Codes & Standards

|          |         |          |           |
|----------|---------|----------|-----------|
| DIN 4109 | EN 1717 | ISO 3822 | Ü-Zeichen |
|----------|---------|----------|-----------|



## Affusion pipe with cover plate - Brushed Durabross (23kt Gold)

---

27 838 979 Product version from 3/2/2021

### Certificates

---

Belgaqua\_21-023-2 LGA\_38

## Affusion pipe with cover plate - Brushed Durabron (23kt Gold)

27 838 979 Product version from 3/2/2021



### Spare parts list

| No. | Item Number        | Name   | Quantity used | Delivery time |
|-----|--------------------|--|---------------|---------------|
| 1   | 04 12 11 073 01-28 | spout  | 1             | 20            |
| 2   | 90 30 02 072 00-28 | Metal shower hose 1/2" x 3/8" x 1250 mm - Brushed Durabron (23kt Gold) | 1             | 20            |
| 3   | 09 16 01 014 90    | ring   | 1             | 2             |
| 4   | 09 23 01 046 90    | back-flow preventer  | 1             | 2             |
| 5   | 90 24 03 212 00 90 | nipple   | 1             | 2             |
| 6   | 09 14 10 008 90    | seal   | 1             | 2             |
| 7   | 09 31 11 026 90    | pin  | 2             | 2             |
| 8   | 09 14 03 127 90    | seal   | 1             | 2             |
| 9   | 09 11 03 046-28    | connection   | 1             | 20            |
| 10  | 90 31 11 004 00 90 | pin  | 1             | 2             |
| 11  | 90 14 10 077 00 90 | seal   | 1             | 2             |
| 12  | 09 24 03 107 20 90 | nipple   | 1             | 2             |
| 13  | 90 21 02 069 00-28 | cover  | 1             | 20            |
| 14  | 90 14 20 026 00 90 | seal   | 1             | 2             |
| 15  | 90 31 11 112 00 90 | pin  | 1             | 2             |
| 16  | 09 17 20 044-28    | holder   | 1             | 20            |
| 17  | 09 18 40 078 90    | sleeve   | 1             | 2             |
| 18  | 05 30 31 025 00 90 | fixing set   | 1             | 2             |
| 19  | 09 11 02 133-28    | plate  | 1             | 20            |
| 20  | 09 24 03 073 90    | nipple   | 1             | 2             |