

## TARA Two-way diverter for bath rim or tile edge installation - Brushed Champagne (22kt Gold)

TARA

29 140 892 Product version from 6/30/2015



- automatic bath/shower diverter
- hole diameter 32 mm
- rosette Ø 55 mm
- 1/2" connection
- max. flow 64.9 l/min at 3 bar flow pressure
- WRAS

|                                                                                     |                                |               |
|-------------------------------------------------------------------------------------|--------------------------------|---------------|
|    | Brushed Champagne (22kt Gold)  | 29 140 892-46 |
|    | Chrome                         | 29 140 892-00 |
|    | Brushed Platinum               | 29 140 892-06 |
|    | Platinum                       | 29 140 892-08 |
|    | Dark Chrome                    | 29 140 892-19 |
|    | Brushed Durabronze (23kt Gold) | 29 140 892-28 |
|    | Matte Black                    | 29 140 892-33 |
|    | Brushed Dark Brass             | 29 140 892-39 |
|    | Brushed Bronze                 | 29 140 892-42 |
|   | Champagne (22kt Gold)          | 29 140 892-47 |
|  | Brushed Chrome                 | 29 140 892-93 |
|  | Brushed Dark Platinum          | 29 140 892-99 |

## TARA Two-way diverter for bath rim or tile edge installation - Brushed Champagne (22kt Gold)

TARA

29 140 892 Product version from 6/30/2015  
mm [inches]

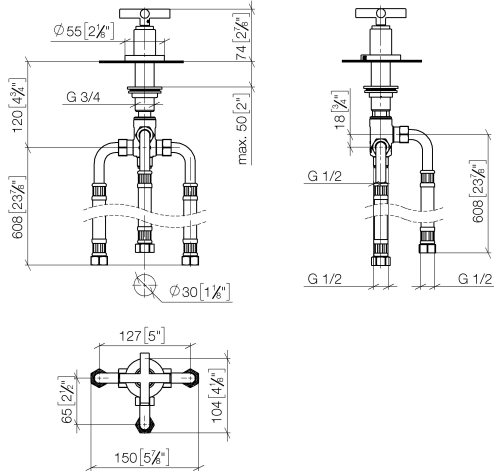

### Flow rate chart



### Codes & Standards

ASME A112.18.1      cUPC      DIN 4109      ISO 3822

### Ü-Zeichen



## TARA Two-way diverter for bath rim or tile edge installation - Brushed Champagne (22kt Gold)

---

TARA

29 140 892 Product version from 6/30/2015

Certificates and sustainability

---

LGA\_29

IAPMO\_4976

## TARA Two-way diverter for bath rim or tile edge installation - Brushed Champagne (22kt Gold)

TARA

29 140 892 Product version from 6/30/2015

Parts for other  
finishes can be found  
here: [Chrome](#)

