

LISSÉ Single-lever bath mixer for wall mounting without shower set - Brushed Chrome

LISSÉ

| | | | |
|------------|---|--|--|
| 33 200 845 | Product version from 3/9/2016 to 7/16/2018 | | |
| | <ul style="list-style-type: none"> 190-200mm projection circular normal flow automatic bath/shower diverter 3/8" shower outlet slide-on rosettes Ø 60 mm 1/2" connection gauge 150 mm - 15 mm max. flow 13.5 l/min at 3 bar flow pressure WRAS | | |
| | Intrinsic protection against back flow. | | |
| | | <div> <div></div> <div>Brushed Chrome</div> <div>33 200 845-93</div> </div> | |
| | | <div> <div></div> <div>Chrome</div> <div>33 200 845-00</div> </div> | |
| | | <div> <div></div> <div>Brushed Platinum</div> <div>33 200 845-06</div> </div> | |
| | | <div> <div></div> <div>Dark Chrome</div> <div>33 200 845-19</div> </div> | |
| | | <div> <div></div> <div>Brushed Light Gold</div> <div>33 200 845-27</div> </div> | |
| | | <div> <div></div> <div>Matte Black</div> <div>33 200 845-33</div> </div> | |
| | | <div> <div></div> <div>Brushed Dark Platinum</div> <div>33 200 845-99</div> </div> | |

LISSÉ Single-lever bath mixer for wall mounting without shower set - Brushed Chrome

LISSÉ

33 200 845 Product version from 3/9/2016 to 7/16/2018
mm [inches]

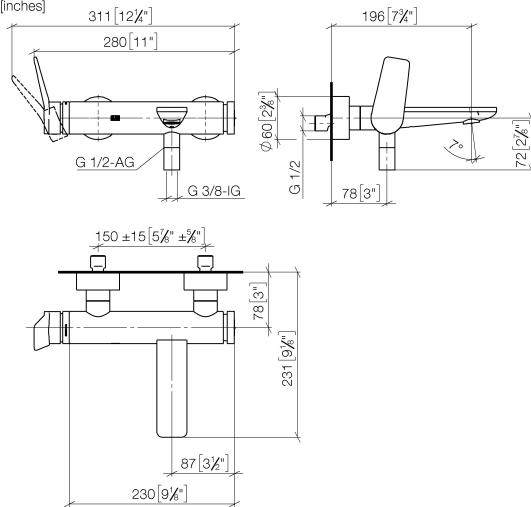

Flow rate chart

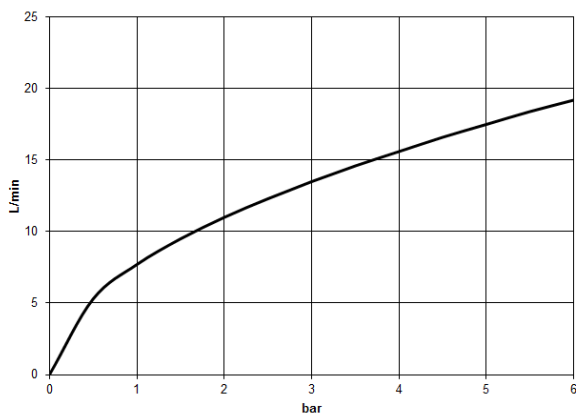

Codes & Standards

ASME A112.18.1 cUPC DIN 4109 ISO 3822

Scottish Water
Byelaws

UK Water Supply
Regulations

Ü-Zeichen



LISSE Single-lever bath mixer for wall mounting without shower set - Brushed Chrome

LISSE

33 200 845 Product version from 3/9/2016 to 7/16/2018

Certificates and sustainability

LGA_9 WRAS_2311 IAPMO_4976 (

LISSÉ Single-lever bath mixer for wall mounting without shower set - Brushed Chrome

LISSÉ

33 200 845 Product version from 3/9/2016 to 7/16/2018

Parts for other
finishes can be found
here: [Chrome](#)





LISSE Single-lever bath mixer for wall mounting without shower set - Brushed Chrome

LISSE

33 200 845 Product version from 3/9/2016 to 7/16/2018

Spare parts list

| No. | Item Number | Name | Quantity used | Delivery time |
|-----|--------------------|---------------------|---------------|---------------|
| 12 | 09 14 10 119 90 | seal | 2.00 | 2 |
| 4 | 90 31 20 087 00-93 | plug | 1.00 | 20 |
| 20 | 09 11 84 012-93 | spout | 1.00 | 20 |
| 1 | 09 20 84 021-93 | handle | 1.00 | 20 |
| 26 | 09 14 10 001 90 | seal | 2.00 | 2 |
| 5 | 09 14 10 102 90 | seal | 1.00 | 2 |
| 9 | 90 15 05 064 00 90 | cartridge | 1.00 | 2 |
| 27 | 09 30 30 113 20 90 | screw | 2.00 | 2 |
| 3 | 09 28 30 032-93 | cover | 1.00 | 20 |
| 6 | 09 14 10 190 90 | seal | 1.00 | 2 |
| 30 | 09 21 10 035 20-93 | nipple | 1.00 | 20 |
| 18 | 09 24 04 043 90 | nipple | 1.00 | 2 |
| 29 | 09 14 10 101 90 | seal | 1.00 | 2 |
| 17 | 09 14 10 003 90 | seal | 1.00 | 2 |
| 21 | 90 23 01 161 00-93 | aerator | 1.00 | 20 |
| 16 | 09 18 40 059-93 | sleeve | 2.00 | 20 |
| 11 | 09 27 62 004-93 | rosette | 2.00 | 20 |
| 28 | 90 31 09 032 00-93 | diverter | 1.00 | 20 |
| 7 | 09 24 04 296 90 | nut | 1.00 | 2 |
| 10 | 04 11 04 030 00 90 | connection | 2.00 | 2 |
| 15 | 09 23 10 048-93 | nut | 2.00 | 20 |
| 14 | 09 14 10 008 90 | seal | 2.00 | 2 |
| 23 | 09 24 03 115 20-93 | nipple | 1.00 | 20 |
| 31 | 09 20 62 031-93 | handle | 1.00 | 20 |
| 24 | 90 14 10 032 00 90 | seal | 1.00 | 2 |
| 22 | 90 21 02 069 00-93 | cover | 1.00 | 20 |
| 8 | 90 28 10 148 00 90 | accessories | 1.00 | 2 |
| 2 | 90 31 11 030 00 90 | pin | 2.00 | 2 |
| 19 | 90 14 10 011 00 90 | seal | 1.00 | 2 |
| 25 | 90 23 01 141 00 90 | back-flow preventer | 1.00 | 2 |
| 13 | 09 29 05 005 20 90 | nipple | 2.00 | 60 |