

## MEM Single-lever mixer - Platinum

MEM

33 815 682



- 241mm projection
- pivotable spout 360°
- Optional swivel limiter available with swivel limiter set 12 820 970 90
- air-enriched flow
- max. flow 6.3 l/min at 3 bar flow pressure
- lead-free
- This product can help a building meet the requirements of Green Building Rating Systems, e.g. LEED®, BREEAM®, DGNB

|                                                                                    |                               |               |
|------------------------------------------------------------------------------------|-------------------------------|---------------|
|   | Platinum                      | 33 815 682-08 |
|   | Chrome                        | 33 815 682-00 |
|   | Brushed Platinum              | 33 815 682-06 |
|   | Durabrand (23kt Gold)         | 33 815 682-09 |
|   | Dark Chrome                   | 33 815 682-19 |
|   | Brushed Durabrand (23kt Gold) | 33 815 682-28 |
|   | Matte Black                   | 33 815 682-33 |
|   | Brushed Champagne (22kt Gold) | 33 815 682-46 |
|   | Champagne (22kt Gold)         | 33 815 682-47 |
|   | Brushed Chrome                | 33 815 682-93 |
|  | Brushed Dark Platinum         | 33 815 682-99 |

### Recommended miscellaneous

**Swivel limitation set -**

12 820 970 90



### Recommended miscellaneous

**Dispenser without rosette -  
Platinum**

82 424 970-08



### Recommended miscellaneous

**Strainer waste with control handle  
- Platinum**

10 712 970-08



33 815 682

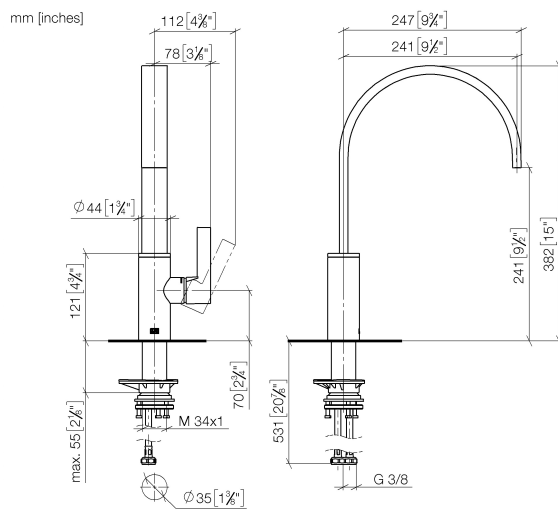

**Flow rate chart**

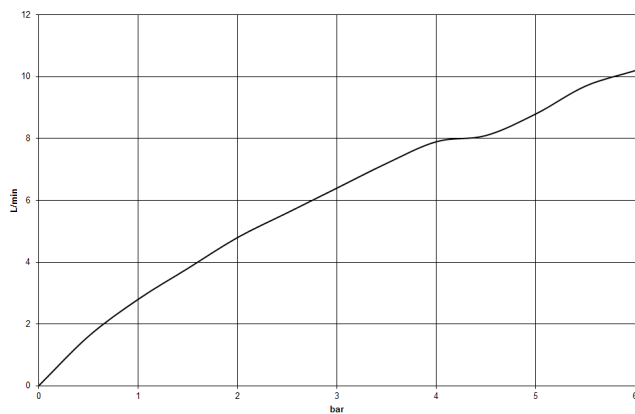

## Certificates

LGA\_38646.

33 815 682

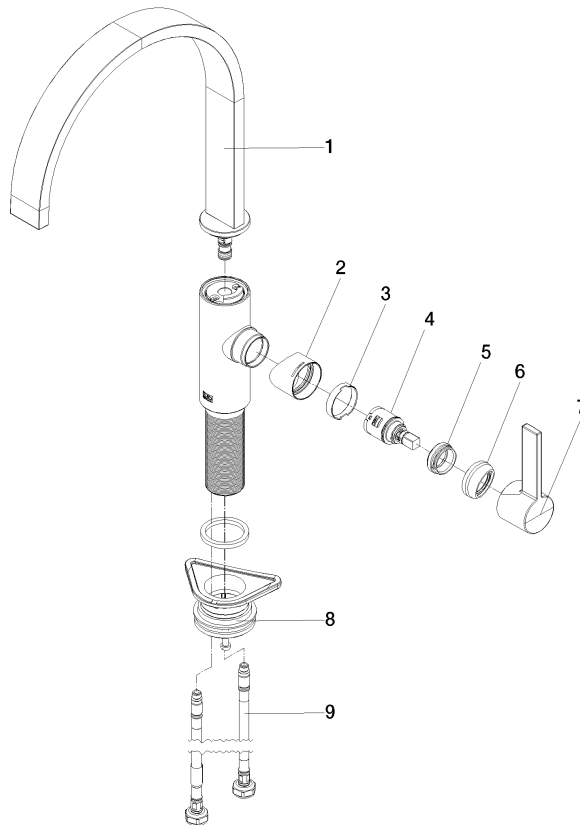

## Spare parts list

| No.                                                                    | Item Number        | Name       | Quantity used | Delivery time |
|------------------------------------------------------------------------|--------------------|------------|---------------|---------------|
| 1                                                                      | 90 28 22 333 00-08 | spout      | 1             | -             |
| Spare part can no longer be ordered, please order the replacement item |                    |            |               |               |
| 2                                                                      | 09 19 86 012-08    | cover      | 1             | 60            |
| 3                                                                      | 90 23 10 128 00 90 | nut        | 1             | 2             |
| 4                                                                      | 90 15 05 042 00 90 | cartridge  | 1             | 2             |
| 5                                                                      | 09 24 04 266 90    | nut        | 1             | 2             |
| 6                                                                      | 90 28 30 052 00-08 | cover      | 1             | 40            |
| 7                                                                      | 90 20 86 004 00-08 | handle     | 1             | 40            |
| 8                                                                      | 04 23 10 044 08 90 | fixing set | 1             | 2             |
| 9                                                                      | 04 30 04 100 00 90 | hose       | 2             | 2             |