

META SQUARE Single-lever mixer - Durabron (23kt Gold)

META SQUARE

33 815 861



- 235mm projection
- pivotable spout 360°
- Optional swivel limiter available with swivel limiter set 12 820 970 90
- air-enriched flow
- max. flow 8 l/min at 3 bar flow pressure
- lead-free
- This product can help a building meet the requirements of Green Building Rating Systems, e.g. LEED®, BREEAM®, DGNB
- WRAS 240102021

| | | |
|--|-------------------------------|---------------|
| | Durabron (23kt Gold) | 33 815 861-09 |
| | Chrome | 33 815 861-00 |
| | Brushed Platinum | 33 815 861-06 |
| | Platinum | 33 815 861-08 |
| | Dark Chrome | 33 815 861-19 |
| | Brushed Durabron (23kt Gold) | 33 815 861-28 |
| | Matte Black | 33 815 861-33 |
| | Brushed Champagne (22kt Gold) | 33 815 861-46 |
| | Champagne (22kt Gold) | 33 815 861-47 |
| | Brushed Chrome | 33 815 861-93 |
| | Brushed Dark Platinum | 33 815 861-99 |

Recommended miscellaneous

| | | |
|--|--------------------------------|---------------|
| | Swivel limitation set - | 12 820 970 90 |
|--|--------------------------------|---------------|

Recommended miscellaneous

| | | |
|--|---|---------------|
| | Dispenser without rosette - Durabron (23kt Gold) | 82 424 970-09 |
|--|---|---------------|

Recommended miscellaneous

| | | |
|--|--|---------------|
| | Strainer waste with control handle - Durabron (23kt Gold) | 10 712 970-09 |
|--|--|---------------|

33 815 861

mm [inches]



Flow rate chart



Codes & Standards

DIN 4109

ISO 3822

Scottish Water
Byelaws

UK Water Supply
Regulations

Ü-Zeichen



META SQUARE Single-lever mixer - Durabrass (23kt Gold)

META SQUARE

33 815 861

Certificates

LGA_38

WRAS_240102

Product version from 2/1/2023

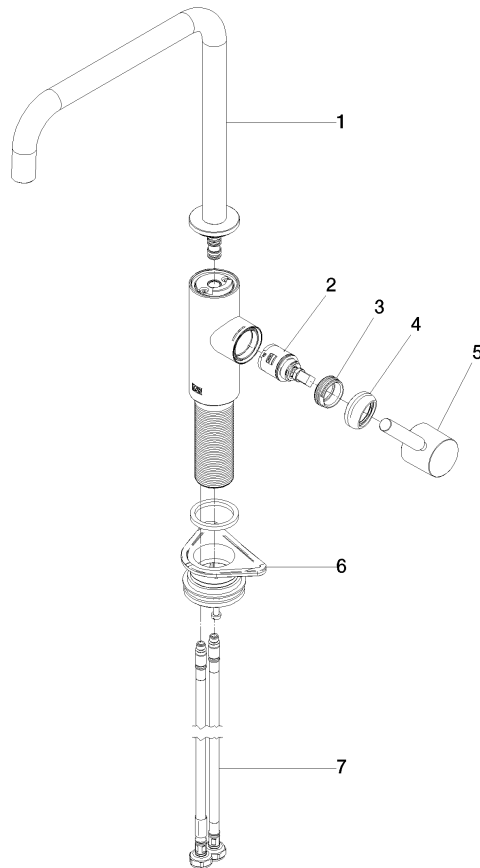



META SQUARE Single-lever mixer - Durabrass (23kt Gold)

META SQUARE

33 815 861

Spare parts list

Product version from 2/1/2023

| No. | Item Number | Name | Quantity used | Delivery time |
|-----|--------------------|-------|---------------|---------------|
| | 90 28 22 284 00-09 | spout | 8 | 40 |