

## Concealed single-lever mixer with integrated shower connection with hand shower set without hand shower - Platinum

IMO

36 002 970



Fits: IMO, LULU, MADISON, MEM, TARA, CL.1, LISSÉ, VAIA, META, CYO









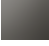

- metal shower hose 1750mm with integrated anti-twist protection
- WRAS 2011027

**This article does not include a hand shower!**

**Intrinsic protection against back flow.**

This article does not include a hand shower!

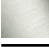
Intrinsic protection against back flow.

	Platinum	36 002 970-08
	Chrome	36 002 970-00
	Brushed Platinum	36 002 970-06
	Dark Chrome	36 002 970-19
	Brushed Light Gold	36 002 970-27
	Brushed Durabronze (23kt Gold)	36 002 970-28
	Matte Black	36 002 970-33
	Brushed Bronze	36 002 970-42
	Brushed Champagne (22kt Gold)	36 002 970-46
	Champagne (22kt Gold)	36 002 970-47
	Brushed Chrome	36 002 970-93
	Brushed Dark Platinum	36 002 970-99

## Concealed single-lever mixer with integrated shower connection with hand shower set without hand shower - Platinum

IMO

36 002 970

### Required miscellaneous



**Concealed wall mounting -**  
 • max. recess depth 105 mm  
 • min. recess depth 80 mm

35 050 970 90

### Required miscellaneous



**Hand shower - Platinum**

28 017 979-08

### Required miscellaneous



**Hand shower - Platinum**

28 012 979-08

### Required miscellaneous



**Hand shower - Platinum**

28 018 979-08

### Required miscellaneous



**SERIES-VARIOUS Hand shower - Platinum**

28 029 979-08 0010

### Required miscellaneous



**SERIES-VARIOUS Hand shower - Platinum**

28 027 979-08 0010

### Required miscellaneous



**Hand shower FlowReduce - Platinum**

28 012 979-08 0010

### Required miscellaneous



**Hand shower - Platinum**

28 016 979-08

### Required miscellaneous



**Hand shower FlowReduce - Platinum**

28 016 979-08 0010

### Required miscellaneous



**Hand shower FlowReduce - Platinum**

28 018 979-08 0010

### Required miscellaneous



**SERIES-VARIOUS Hand shower - Platinum**

28 029 979-08

### Required miscellaneous



**SERIES-VARIOUS Hand shower - Platinum**

28 025 979-08 0010

Concealed single-lever mixer with integrated shower connection with hand shower set without hand shower - Platinum

IMO

36 002 970  
mm [inches]

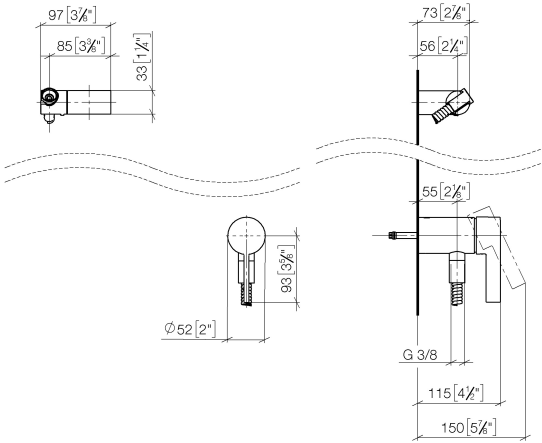

Codes & Standards

DIN 4109	EN 1717	ISO 3822	Scottish Water Byelaws
UK Water Supply Regulations	Ü-Zeichen		

Certificates

Belgaqua\_21-025-2 WRAS\_2011 LGA\_29

Concealed single-lever mixer with integrated shower connection with hand shower set without hand shower - Platinum

IMO

36 002 970

**Product version from 10/1/2023**

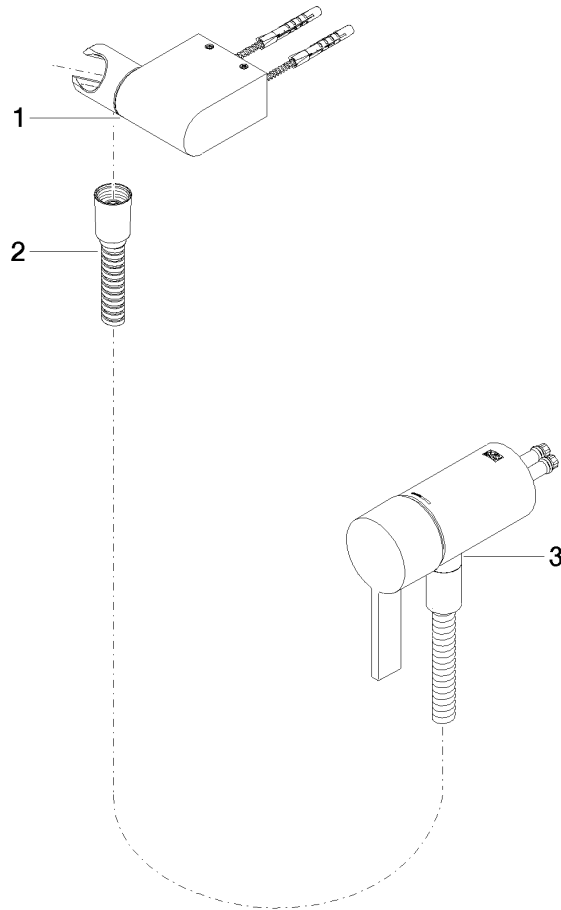



Concealed single-lever mixer with integrated shower connection with hand shower set without hand shower - Platinum

IMO

36 002 970

## Spare parts list

Product version from 10/1/2023

No.	Item Number	Name	Quantity used	Delivery time
	28 060 970-08	Wall bracket swivel - Platinum	3	40