

## TARA Wall valve clockwise closing 1/2" - Dark Chrome

36 607 892

- rosette Ø 55 mm
- head part with cut-to-length spindle and sleeve
- WRAS



	Dark Chrome	36 607 892-19
	Chrome	36 607 892-00
	Brushed Platinum	36 607 892-06
	Platinum	36 607 892-08
	Brushed Durabronze (23kt Gold)	36 607 892-28
	Matte Black	36 607 892-33
	Brushed Bronze	36 607 892-42
	Brushed Champagne (22kt Gold)	36 607 892-46
	Champagne (22kt Gold)	36 607 892-47
	Brushed Chrome	36 607 892-93
	Brushed Dark Platinum	36 607 892-99

### Required miscellaneous

#### Wall valve 1/2" -

35 607 970 90



- max. recess depth mm
- min. recess depth mm



TARA Wall valve clockwise closing 1/2" - Dark Chrome

36 607 892

mm [inches]

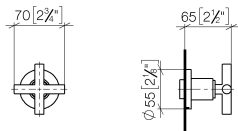

Codes & Standards				
ASME A112.18.1	cUPC	DIN 4109	EN 1111	
EN 200	ISO 3822	Scottish Water Byelaws	UK Water Supply Regulations	
Ü-Zeichen				
Certificates				
DVGW_DW-6501DN0	WRAS_2011	LGA_29	WRAS_2010	DVGW_DW-6512DN0
IAPMO_4976 (				

## TARA Wall valve clockwise closing 1/2" - Dark Chrome

36 607 892

