

## MEM Bath cascade spout for wall mounting - Chrome

MEM

13 430 730

- 220mm projection
- cascade
- plate 78 mm x 192 mm
- 1/2" connection
- plug-link mounting
- max. flow 26.5 l/min at 3 bar flow pressure



### Recommended miscellaneous

#### **Concealed wall elbow -** 35 085 970 90



- max. recess depth 163 mm
- min. recess depth 90 mm

13 430 730

mm [inches]

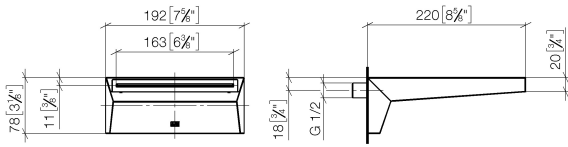

Flow rate chart

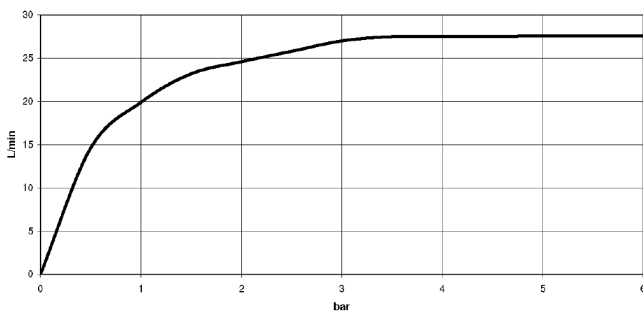

Trajectory diagram

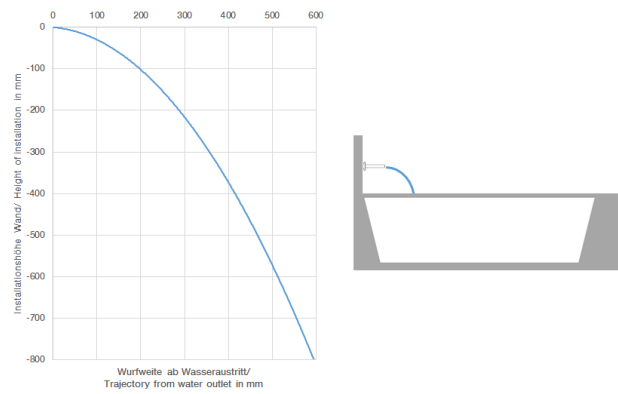

Codes & Standards

ASME A112.18.1

cUPC

DIN 4109

ISO 3822

Ü-Zeichen



## MEM Bath cascade spout for wall mounting - Chrome

---

MEM

13 430 730

### Certificates

---

LGA\_19

IAPMO\_4976

13 430 730

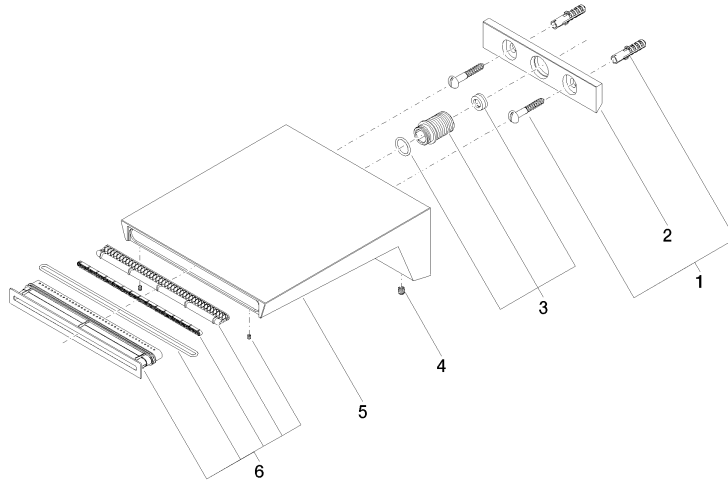



## MEM Bath cascade spout for wall mounting - Chrome

MEM

13 430 730

### Spare parts list

| No. | Item Number        | Name       | Quantity used | Delivery time |
|-----|--------------------|------------|---------------|---------------|
|     | 04 30 31 024 01 90 | fixing set | 8             | 2             |