

**MEM Wall-mounted basin spout without pop-up waste - Platinum**

MEM

13 800 782



- 200mm projection
- fixed spout
- rectangular, air-enriched flow
- hole diameter 37 mm
- rosette 60 x 60 mm
- 1/2" connection
- max. flow 5.7 l/min
- lead-free
- WRAS 2203039
- This product can help a building meet the requirements of Green Building Rating Systems, e.g. LEED®, BREEAM®, DGNB

|  |                                |               |
|--|--------------------------------|---------------|
|  | Platinum                       | 13 800 782-08 |
|  | Chrome                         | 13 800 782-00 |
|  | Brushed Platinum               | 13 800 782-06 |
|  | Dark Chrome                    | 13 800 782-19 |
|  | Brushed Durabronze (23kt Gold) | 13 800 782-28 |
|  | Brushed Champagne (22kt Gold)  | 13 800 782-46 |
|  | Champagne (22kt Gold)          | 13 800 782-47 |
|  | Brushed Dark Platinum          | 13 800 782-99 |

**Recommended miscellaneous**



**Concealed wall elbow -**

35 085 970 90

- max. recess depth 163 mm
- min. recess depth 90 mm

13 800 782

mm [inches]

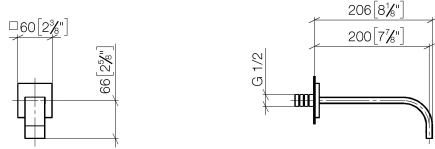

**Flow rate chart**

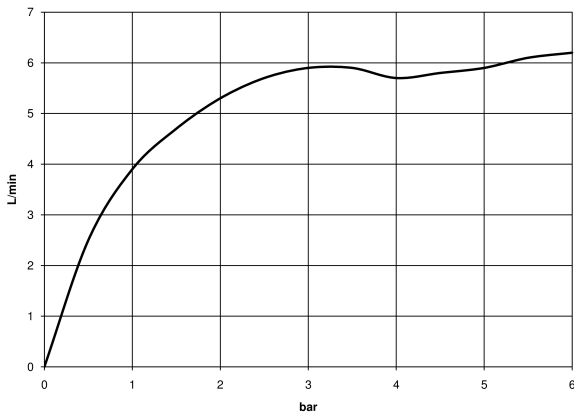

**Codes & Standards**

Scottish Water  
Byelaws

UK Water Supply  
Regulations



## MEM Wall-mounted basin spout without pop-up waste - Platinum

---

MEM

13 800 782

Certificates

---

WRAS\_2203

13 800 782

Product version from 3/10/2014

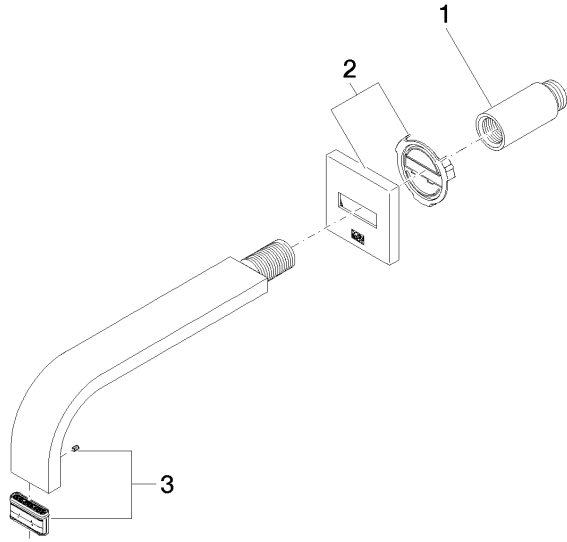



MEM Wall-mounted basin spout without pop-up waste - Platinum

MEM

13 800 782

**Spare parts list**

**Product version from 3/10/2014**

| No. | Item Number        | Name      | Quantity used | Delivery time |
|-----|--------------------|-----------|---------------|---------------|
|     | 09 24 03 081 10 90 | extension | 3             | 2             |