

## MEM Bath spout for wall mounting - Platinum

MEM

13 801 782 Product version from 3/10/2014



- 220mm projection
- rectangular, air-enriched flow
- rosette 60 x 60 mm
- hole diameter 37 mm
- 1/2" connection
- max. flow 38.5 l/min at 3 bar flow pressure
- WRAS

	Platinum	13 801 782-08
	Chrome	13 801 782-00
	Brushed Platinum	13 801 782-06
	Dark Chrome	13 801 782-19
	Brushed Durabronze (23kt Gold)	13 801 782-28
	Brushed Champagne (22kt Gold)	13 801 782-46
	Champagne (22kt Gold)	13 801 782-47
	Brushed Dark Platinum	13 801 782-99

### Recommended miscellaneous



**Concealed wall elbow -**

35 085 970 90

- max. recess depth 163 mm
- min. recess depth 90 mm

**MEM Bath spout for wall mounting - Platinum**

MEM

13 801 782 Product version from 3/10/2014

mm [inches]

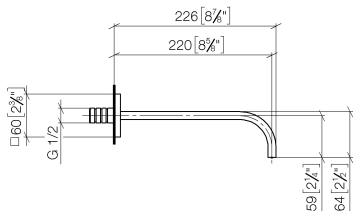

**Flow rate chart**

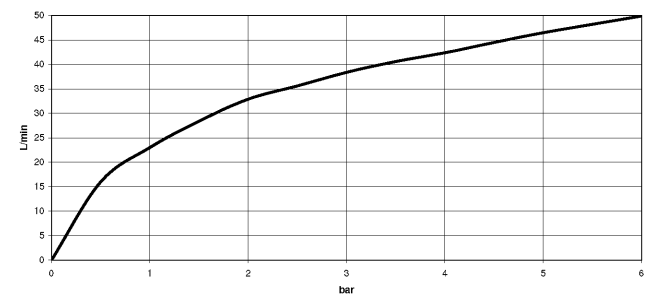

**Codes & Standards**

ASME A112.18.1

cUPC

Scottish Water  
Byelaws

UK Water Supply  
Regulations



## MEM Bath spout for wall mounting - Platinum

---

MEM

13 801 782 Product version from 3/10/2014

### Certificates and sustainability

---

WRAS\_2203

IAPMO\_4976

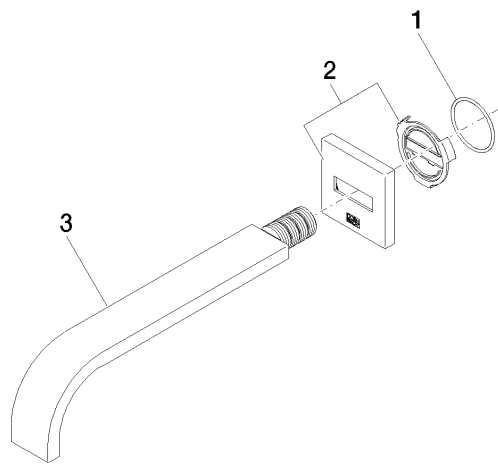

Spare parts list

No.	Item Number	Name	Quantity used	Delivery time
1	09 14 10 111 90	seal	1.00	2
2	90 27 78 035 00-08	rosette	1.00	40
3	04 28 22 290 00-08	spout	1.00	40