

**MEM Bath spout for wall mounting - Dark Chrome**

MEM

13 801 782



- 220mm projection
- rectangular, air-enriched flow
- rosette 60 x 60 mm
- hole diameter 37 mm
- 1/2" connection
- max. flow 38.5 l/min at 3 bar flow pressure
- WRAS 2203039

|  |                                     |               |
|--|-------------------------------------|---------------|
|  | Dark Chrome                         | 13 801 782-19 |
|  | Chrome                              | 13 801 782-00 |
|  | Brushed Platinum                    | 13 801 782-06 |
|  | Platinum                            | 13 801 782-08 |
|  | Brushed Durabronze<br>(23kt Gold)   | 13 801 782-28 |
|  | Brushed<br>Champagne (22kt<br>Gold) | 13 801 782-46 |
|  | Champagne (22kt<br>Gold)            | 13 801 782-47 |
|  | Brushed Dark<br>Platinum            | 13 801 782-99 |

13 801 782

mm [inches]

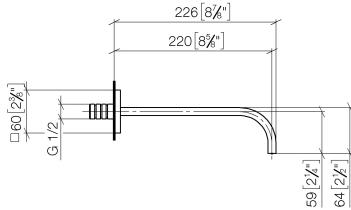

**Flow rate chart**



**Codes & Standards**

Scottish Water  
Byelaws

UK Water Supply  
Regulations



## MEM Bath spout for wall mounting - Dark Chrome

---

MEM

13 801 782

Certificates

---

WRAS\_2203

13 801 782

Parts for other  
finishes can be found  
here: [Chrome](#)

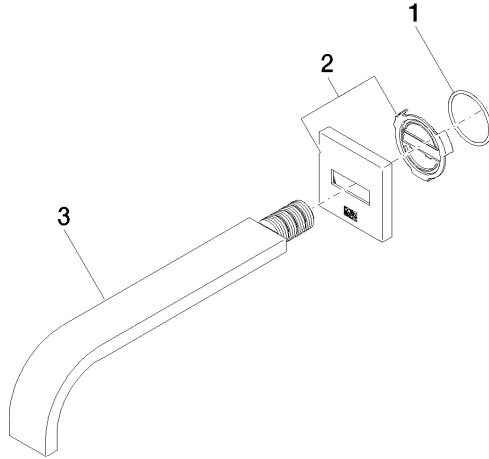



## MEM Bath spout for wall mounting - Dark Chrome

---

MEM

13 801 782

### **Spare parts list**