

MADISON Rain shower with wall fixing FlowReduce 200 mm - Brushed Durabrand (23kt Gold)

MADISON

28 544 977



- 435mm projection
- rain shower Ø 200 mm
- rain flow
- max. flow 7 l/min
- Function from: 6.5 l/min
- rosette Ø 55 mm
- 1/2" connection
- with anti-scale system
- This product can help a building meet the requirements of Green Building Rating Systems, e.g. LEED®, BREEAM®, DGNB

	Brushed Durabrand (23kt Gold)	28 544 977-28
	Chrome	28 544 977-00
	Brushed Platinum	28 544 977-06
	Platinum	28 544 977-08
	Durabrand (23kt Gold)	28 544 977-09
	Brushed Dark Platinum	28 544 977-99

MADISON Rain shower with wall fixing FlowReduce 200 mm - Brushed Durabron (23kt Gold)

MADISON

28 544 977
mm [inches]



Flow rate chart

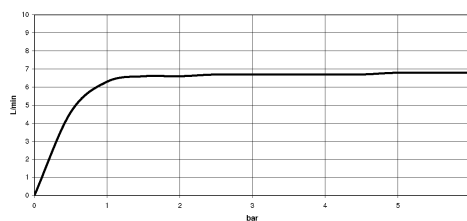

Codes & Standards

DIN 4109

ISO 3822

Scottish Water
Byelaws

UK Water Supply
Regulations

Ü-Zeichen



MADISON Rain shower with wall fixing FlowReduce 200 mm - Brushed Durabrass (23kt Gold)

MADISON

28 544 977

Certificates and sustainability

LGA_38

WRAS_250102

MADISON Rain shower with wall fixing FlowReduce 200 mm - Brushed Durabronz (23kt Gold)
MADISON

28 544 977
Parts for other
finishes can be found
here: Chrome

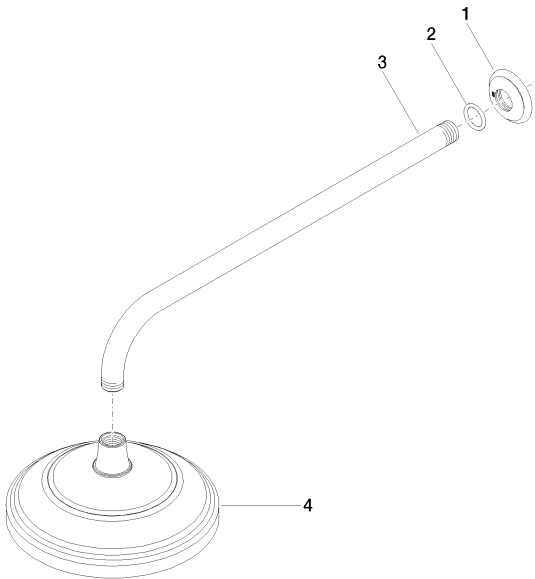

Spare parts list

No.	Item Number	Name	Quantity used	Delivery time
1	09 27 35 003-28	rosette	1.00	60
2	90 14 10 026 00 90	seal	1.00	2
4	90 12 05 038 20-28	shower	1.00	20
3	09 11 03 017-28	connection	1.00	60