







## LISSÉ Bath spout for wall mounting - Matte Black

LISSÉ

13 801 845 Product version from 3/9/2016

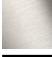

- 210mm projection
- circular normal flow
- hole diameter 37 mm
- 1/2" connection
- plug-link mounting
- max. flow 21.5 l/min at 3 bar flow pressure
- WRAS

|   |                       |               |
|---|-----------------------|---------------|
|  | Matte Black           | 13 801 845-33 |
|  | Chrome                | 13 801 845-00 |
|  | Brushed Platinum      | 13 801 845-06 |
|  | Dark Chrome           | 13 801 845-19 |
|  | Brushed Light Gold    | 13 801 845-27 |
|  | Brushed Chrome        | 13 801 845-93 |
|  | Brushed Dark Platinum | 13 801 845-99 |

### Recommended miscellaneous



#### Concealed wall elbow -

35 085 970 90

- max. recess depth 163 mm
- min. recess depth 90 mm

mm [inches]

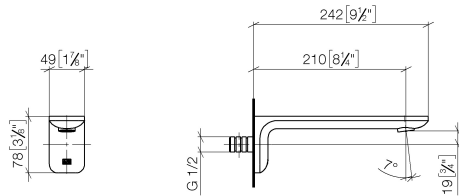

### Flow rate chart



### Codes & Standards

DIN 4109

ISO 3822

Scottish Water  
Byelaws

UK Water Supply  
Regulations

Ü-Zeichen



## LISSE Bath spout for wall mounting - Matte Black

---

LISSE

13 801 845 Product version from 3/9/2016

Certificates and sustainability

---

LGA\_29

WRAS\_2207

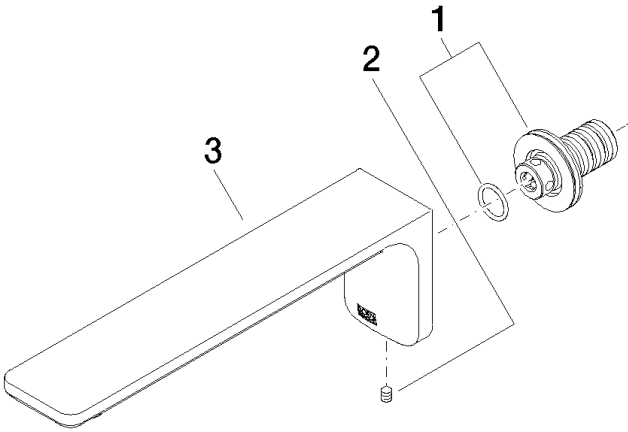

Spare parts list

| No. | Item Number        | Name       | Quantity used | Delivery time |
|-----|--------------------|------------|---------------|---------------|
| 3   | 90 11 84 014 02-33 | spout      | 1.00          | 30            |
| 1   | 90 24 03 108 00 90 | nipple set | 1.00          | 2             |
| 2   | 90 31 11 004 00 90 | pin        | 1.00          | 2             |