

META SQUARE HOT & COLD WATER DISPENSER - Brushed Durabrass (23kt Gold)

META SQUARE

17 861 625 Product version from 3/9/2016 to 5/27/2021



- 145mm projection
 - rigid, thermally insulated spout
 - laminar flow
 - height of mixer 249 mm
 - height up to laminar flow regulator 184 mm
 - hole diameter 35 mm
 - provides filtered, hot water up to 93°C
 - provides filtered, cold water
 - max. flow 2 l/min at 3 bar flow pressure
 - ready-to-use control unit for wall mounting (137mm x 159mm x 60mm)
 - electronic magnetic valve
 - 100-230 V, 50-60 Hz, 18 W power supply unit, incl. country-specific adapter set
 - lead-free
 - Spout ring cannot be removed.
 - This product can help a building meet the requirements of Green Building Rating Systems, e.g. LEED®, BREEAM®, DGNB
- A minimum flow pressure of 3 bar is necessary for the HOT & COLD WATER DISPENSER to work perfectly in conjunction with a hot water tank and filter.**
- The installation must be above a kitchen sink.**
- The filter cartridge must be changed every six months. The installation instructions contain further information for guidance.**
- Detailed planning information and technical data can be found at www.dornbracht.com/professional**
- Not compatible with reverse osmosis filtration**

	Brushed Durabrass (23kt Gold)	17 861 625-28
	Chrome	17 861 625-00
	Brushed Platinum	17 861 625-06
	Platinum	17 861 625-08
	Durabrass (23kt Gold)	17 861 625-09
	Dark Chrome	17 861 625-19
	Matte Black	17 861 625-33
	Brushed Champagne (22kt Gold)	17 861 625-46
	Champagne (22kt Gold)	17 861 625-47
	Brushed Chrome	17 861 625-93
	Brushed Dark Platinum	17 861 625-99

A minimum flow pressure of 3 bar is necessary for the HOT & COLD WATER DISPENSER to work perfectly in conjunction with a hot water tank and filter.

The installation must be above a kitchen sink.

The filter cartridge must be changed every six months. The installation instructions contain further information for guidance.

Detailed planning information and technical data can be found at www.dornbracht.com/professional

Not compatible with reverse osmosis filtration

Required miscellaneous



Hot water tank incl. filter - 12 892 970 90

META SQUARE HOT & COLD WATER DISPENSER - Brushed Durabronss (23kt Gold)

META SQUARE

17 861 625 Product version from 3/9/2016 to 5/27/2021
mm [inches]

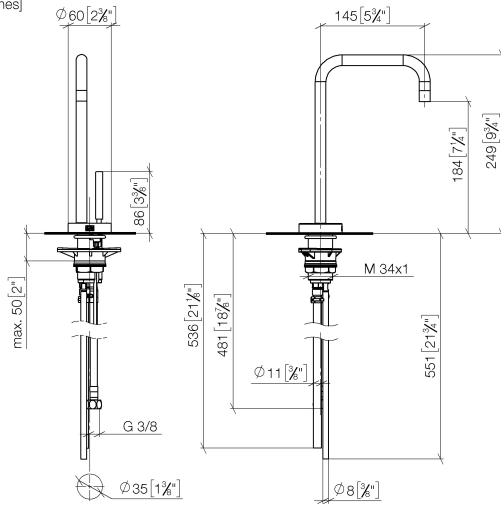

Flow rate chart



Codes & Standards

DIN 4109

Executive Order
no. 1007

ISO 3822

NSF372

NSF61

Ü-Zeichen



META SQUARE HOT & COLD WATER DISPENSER - Brushed Durabross
(23kt Gold)

META SQUARE

17 861 625 Product version from 3/9/2016 to 5/27/2021

Certificates and sustainability

IAPMO_N-4

GDV_0400

LGA_28

IAPMO_6

META SQUARE HOT & COLD WATER DISPENSER - Brushed Durabross (23kt Gold)

META SQUARE

17 861 625 Product version from 3/9/2016 to 5/27/2021

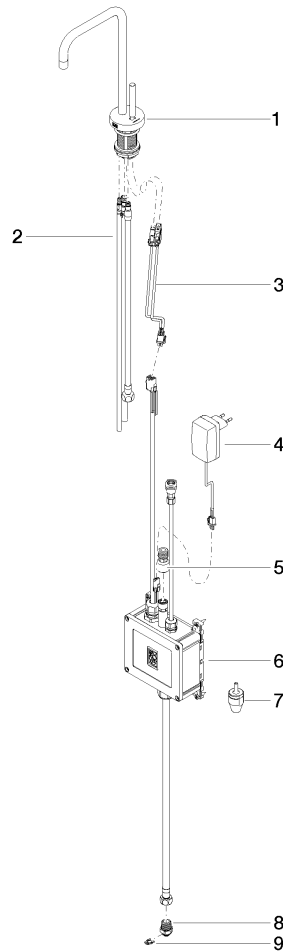

Spare parts list

No.	Item Number	Name	Quantity used	Delivery time
	4 04 10 01 050 00 90	power supply	1.00	60
	5 12 866 970 90	Adapter Flow restrictor HCWD 3/8" -	1.00	2
	3 90 10 01 048 00 90	electronic accessories	1.00	2
	2 90 30 04 067 00 90	hose	1.00	2
	1 90 17 85 100 02-28	fitting	1.00	20
	7 90 24 04 291 00 90	insert	1.00	2
	8 09 24 04 293 90	nipple	1.00	2
	9 09 16 01 045 90	ring	1.00	2
	6 90 11 11 064 01 90	electronic accessories	1.00	2