

17 861 790



- 142mm projection
- rigid, thermally insulated spout
- laminar flow
- height of mixer 248 mm
- height up to laminar flow regulator 226 mm
- hole diameter 35 mm
- provides filtered, hot water up to 93°C
- provides filtered, cold water
- max. flow 2 l/min at 3 bar flow pressure
- ready-to-use control unit for wall mounting (137mm x 159mm x 60mm)
- electronic magnetic valve
- 100-230 V, 50-60 Hz, 18 W power supply unit, incl. country-specific adapter set
- lead-free
- Spout ring cannot be removed.
- This product can help a building meet the requirements of Green Building Rating Systems, e.g. LEED®, BREEAM®, DGNB

A minimum flow pressure of 3 bar is necessary for the HOT & COLD WATER DISPENSER to work perfectly in conjunction with a hot water tank and filter.

In addition, the installation must be above a kitchen sink.

The filter cartridge must be changed every six months. The installation instructions contain further information for guidance.

Detailed planning information and technical data can be found at [www.dornbracht.com/professional](http://www.dornbracht.com/professional)

Brushed Chrome 17 861 790-93

 Chrome 17 861 790-00

 Brushed Platinum 17 861 790-06

 Platinum 17 861 790-08

 Dark Chrome 17 861 790-19

 Brushed Durabronze (23kt Gold) 17 861 790-28

 Brushed Champagne (22kt Gold) 17 861 790-46

 Champagne (22kt Gold) 17 861 790-47

 Brushed Dark Platinum 17 861 790-99

17 861 790

mm [inches]

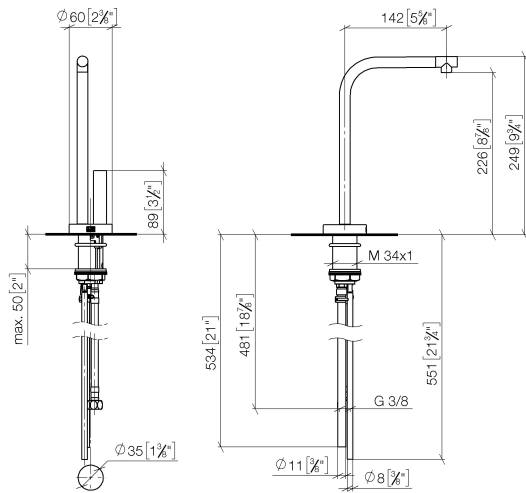

Flow rate chart



Codes & Standards

NSF372

NSF61



## ELIO HOT & COLD WATER DISPENSER - Brushed Chrome

---

ELIO

17 861 790

### Certificates

---

IAPMO\_N-4

IAPMO\_6

**Product version from 5/28/2022**

Parts for other  
finishes can be found  
here: [Chrome](#)

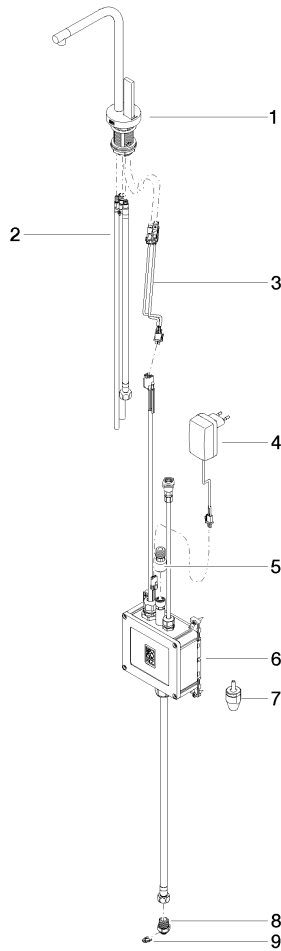



## ELIO HOT & COLD WATER DISPENSER - Brushed Chrome

---

ELIO

17 861 790

### **Spare parts list**

**Product version from 5/28/2022**