

17 861 875



- 146mm projection
- rigid, thermally insulated spout
- laminar flow
- height of mixer 288 mm
- height up to laminar flow regulator 180 mm
- hole diameter 35 mm
- provides filtered, hot water up to 93°C
- provides filtered, cold water
- max. flow 2 l/min at 3 bar flow pressure
- ready-to-use control unit for wall mounting (137mm x 159mm x 60mm)
- electronic magnetic valve
- 100-230 V, 50-60 Hz, 18 W power supply unit, incl. country-specific adapter set
- lead-free
- Spout ring cannot be removed.
- This product can help a building meet the requirements of Green Building Rating Systems, e.g. LEED®, BREEAM®, DGNB

A minimum flow pressure of 3 bar is necessary for the HOT & COLD WATER DISPENSER to work perfectly in conjunction with a hot water tank and filter.

In addition, the installation must be above a kitchen sink.

The filter cartridge must be changed every six months. The installation instructions contain further information for guidance.

Detailed planning information and technical data can be found at [www.dornbracht.com/professional](http://www.dornbracht.com/professional)

Brushed Chrome

17 861 875-93

	Chrome	17 861 875-00
	Brushed Platinum	17 861 875-06
	Platinum	17 861 875-08
	Durabronze (23kt Gold)	17 861 875-09
	Dark Chrome	17 861 875-19
	Brushed Durabronze (23kt Gold)	17 861 875-28
	Matte Black	17 861 875-33
	Brushed Champagne (22kt Gold)	17 861 875-46
	Champagne (22kt Gold)	17 861 875-47
	Brushed Dark Platinum	17 861 875-99

Technical drawing of the M34x1 threaded rod assembly. The drawing shows a side view and a top view. The side view shows a threaded rod with a hex nut and a washer. The top view shows the rod passing through a plate with a hole. Dimensions are given in mm and inches.

Dimensions (mm [inches]):

- Top view:  $\phi 80$  [2 3/4"], 154 [6"], 146 [5 3/4"], 180 [7 1/4"], 288 [11 3/4"]
- Side view: max. 50 [2"],  $\phi 60$  [2 3/4"], 89 [3 1/2"], 534 [21"], 481 [18 5/8"], 551 [21 3/4"],  $\phi 11$  [3/8"],  $\phi 8$  [5/8"],  $\phi 35$  [1 3/4"]
- Threaded rod: M 34x1
- Washer: G 3/8

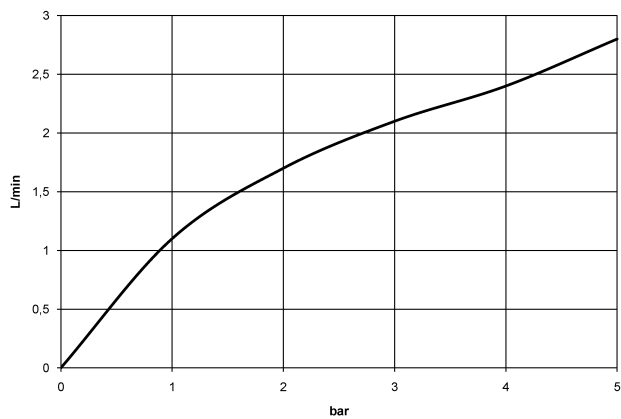

Executive Order no. 1007	NSF372	NSF61
-----------------------------	--------	-------



## TARA ULTRA HOT & COLD WATER DISPENSER - Brushed Chrome

TARA ULTRA

17 861 875

### Certificates

GDV\_0400

IAPMO\_N-4

IAPMO\_6

17 861 875

**Product version from 5/28/2022**

Parts for other  
finishes can be found  
here: [Chrome](#)

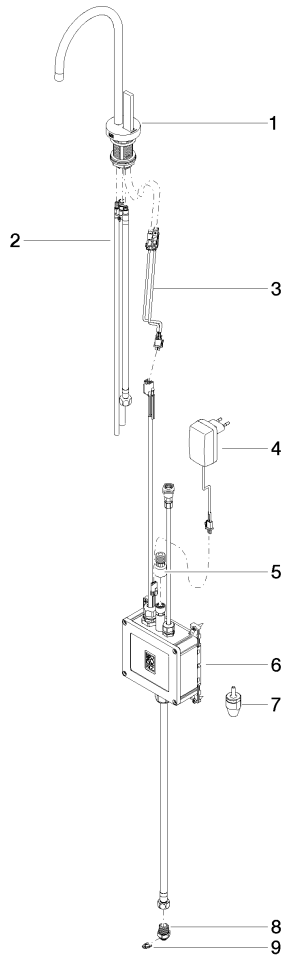



## TARA ULTRA HOT & COLD WATER DISPENSER - Brushed Chrome

TARA ULTRA

17 861 875

### **Spare parts list**

**Product version from 5/28/2022**