

## Shower set without hand shower - Platinum

IMO

26 413 980



Fits: IMO, MEM, CL.1, CYO

- slide bar
- Pipe diameter 18 mm
- rosette 60 x 60 mm
- gauge 800 mm
- metal shower hose 1750mm with integrated anti-twist protection
- shower hose connector 3/8"
- WRAS 2009048

This article does not include a hand shower!

	Platinum	26 413 980-08
	Chrome	26 413 980-00
	Brushed Platinum	26 413 980-06
	Dark Chrome	26 413 980-19
	Brushed Light Gold	26 413 980-27
	Brushed Durabronze (23kt Gold)	26 413 980-28
	Matte Black	26 413 980-33
	Brushed Champagne (22kt Gold)	26 413 980-46
	Champagne (22kt Gold)	26 413 980-47
	Brushed Chrome	26 413 980-93
	Brushed Dark Platinum	26 413 980-99

## Shower set without hand shower - Platinum

IMO

26 413 980

### Recommended miscellaneous



**Concealed wall elbow -**  
 • max. recess depth 163 mm  
 • min. recess depth 90 mm

35 085 970-90

### Required miscellaneous



**Hand shower FlowReduce -**  
**Platinum**

28 016 979-08  
 0010

### Required miscellaneous



**Hand shower - Platinum**

28 017 979-08

### Required miscellaneous



**Hand shower - Platinum**

28 012 979-08

### Required miscellaneous



**Hand shower FlowReduce -**  
**Platinum**

28 018 979-08  
 0010

### Required miscellaneous



**SERIES-VARIOUS Hand shower -**  
**Platinum**

28 029 979-08

### Required miscellaneous



**SERIES-VARIOUS Hand shower -**  
**Platinum**

28 027 979-08  
 0010

### Recommended miscellaneous



**Wall elbow - Platinum**

28 450 980-08

### Required miscellaneous



**Hand shower FlowReduce -**  
**Platinum**

28 012 979-08  
 0010

### Required miscellaneous



**Hand shower - Platinum**

28 016 979-08

### Required miscellaneous



**Hand shower - Platinum**

28 018 979-08

### Required miscellaneous



**SERIES-VARIOUS Hand shower -**  
**Platinum**

28 029 979-08  
 0010

### Required miscellaneous



**SERIES-VARIOUS Hand shower -**  
**Platinum**

28 025 979-08  
 0010

Shower set without hand shower - Platinum

IMO

26 413 980

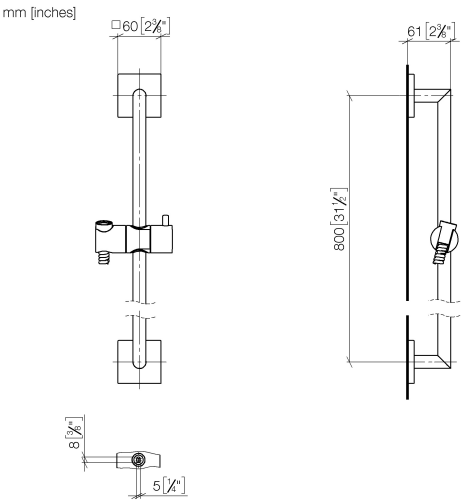

Codes & Standards

ASME A112.18.1	cUPC	Scottish Water Byelaws	UK Water Supply Regulations
XP P 41-280			

Certificates

IAPMO_4976	WRAS_2009	ACS_20 ACC LY
------------	-----------	---------------

**Product version from 6/1/2024**

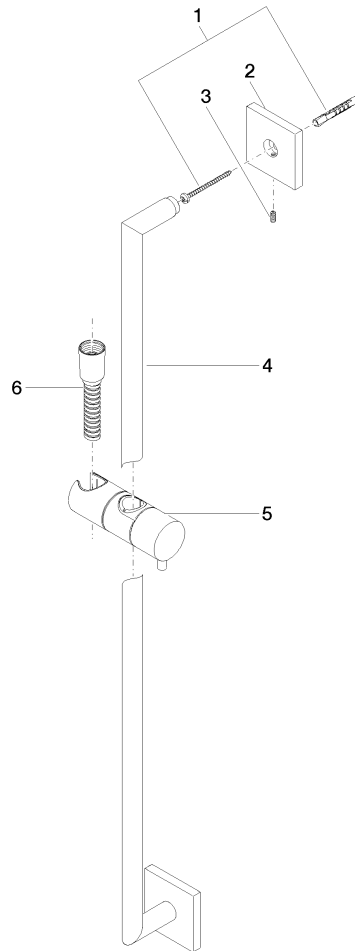



## Shower set without hand shower - Platinum

IMO

26 413 980

### Spare parts list

#### Product version from 6/1/2024

No.	Item Number	Name	Quantity used	Delivery time
	05 30 31 025 00 90	fixing set	9	2