

TARA Two-way diverter for bath rim or tile edge installation - Champagne (22kt Gold)

TARA

29 140 892 Product version from 6/30/2015



- automatic bath/shower diverter
- hole diameter 32 mm
- rosette Ø 55 mm
- 1/2" connection
- max. flow 64.9 l/min at 3 bar flow pressure
- WRAS

| | | |
|---|--------------------------------|---------------|
|  | Champagne (22kt Gold) | 29 140 892-47 |
|  | Chrome | 29 140 892-00 |
|  | Brushed Platinum | 29 140 892-06 |
|  | Platinum | 29 140 892-08 |
|  | Dark Chrome | 29 140 892-19 |
|  | Brushed Durabronze (23kt Gold) | 29 140 892-28 |
|  | Matte Black | 29 140 892-33 |
|  | Brushed Bronze | 29 140 892-42 |
|  | Brushed Champagne (22kt Gold) | 29 140 892-46 |
|  | Brushed Chrome | 29 140 892-93 |
|  | Brushed Dark Platinum | 29 140 892-99 |

TARA Two-way diverter for bath rim or tile edge installation - Champagne (22kt Gold)

TARA

29 140 892 Product version from 6/30/2015
mm [inches]

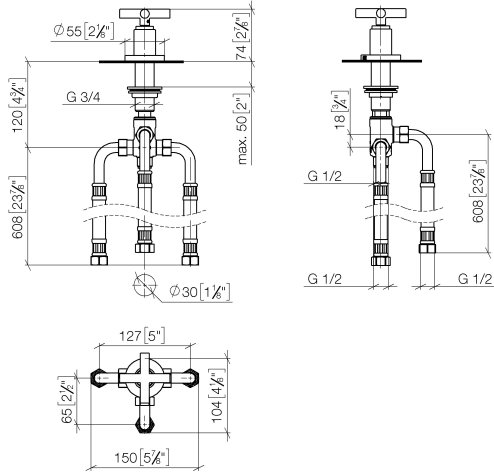

Flow rate chart

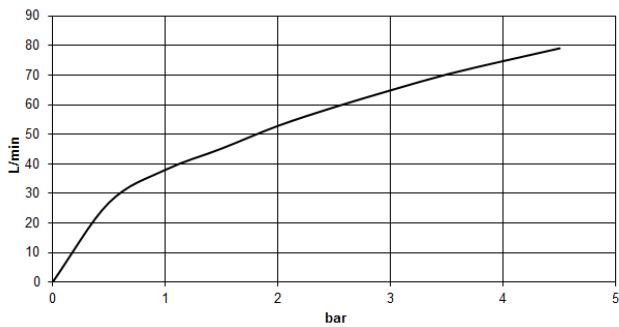

Codes & Standards

DIN 4109

ISO 3822

Ü-Zeichen



TARA Two-way diverter for bath rim or tile edge installation - Champagne (22kt Gold)

TARA

29 140 892 Product version from 6/30/2015

Certificates and sustainability

LGA_29

TARA Two-way diverter for bath rim or tile edge installation - Champagne (22kt Gold)

TARA

29 140 892 Product version from 6/30/2015

Parts for other
finishes can be found
here: [Chrome](#)

