



## DORNBRACHT YARRE Single-lever basin mixer with pop-up waste - Chrome

---

33 501 832



- 120mm projection
- fixed spout
- circular, air-enriched flow
- height of mixer 126 mm
- height up to aerator 80 mm
- hole diameter 35 mm
- 2x screw-in M 8 x 1 pressure hose, leak-tested
- max. flow 6.8 l/min
- WRAS 240104004



Chrome

33 501 832-00



Soft Black

33 501 832-69



DORNBRACHT YARRE Single-lever basin mixer with pop-up waste - Chrome

33 501 832

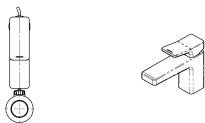
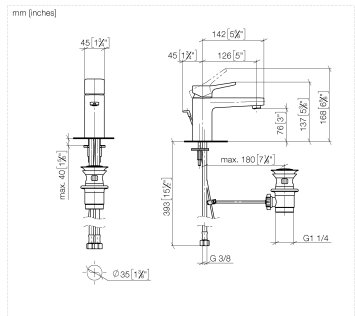

Flow rate chart

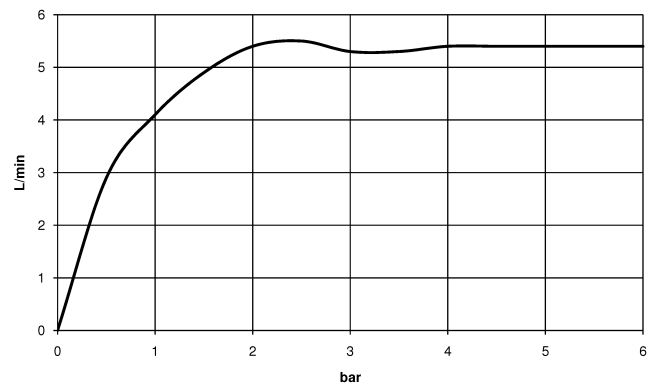

Codes & Standards

DIN 4109	ISO 3822	Scottish Water Byelaws	UK Water Supply Regulations
Ü-Zeichen	XP P 41-280		



## DORNBACHT YARRE Single-lever basin mixer with pop-up waste - Chrome

---

33 501 832

### Certificates

---

AbP\_10

WRAS\_240104

ACS\_23 ACC NY

## DORNBACHT YARRE Single-lever basin mixer with pop-up waste - Chrome

33 501 832

### Product version from 1/1/2023

Parts for other  
finishes can be found  
here: [Soft Black](#)

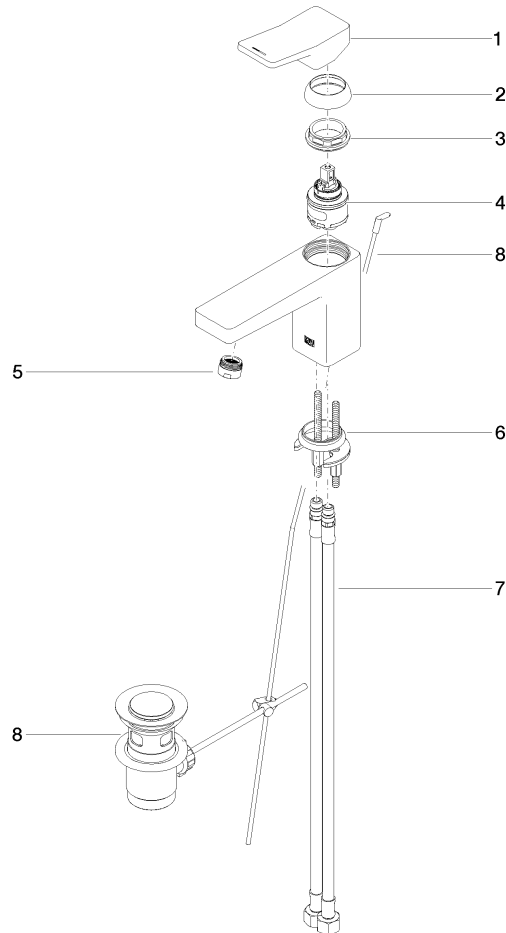



## DORNBACHT YARRE Single-lever basin mixer with pop-up waste - Chrome

---

33 501 832

### Spare parts list

#### Product version from 1/1/2023

No.	Item Number	Name	Quantity used	Delivery time
	90 20 83 004 00-00	handle	9	2