

TARA Concealed thermostat with two function volume control - Dark Chrome

TARA

36 426 892



- rotary diverter with volume control and shut-off function
- cover plate Ø 150 mm
- temperature control handle with safety limit stop at 38°C
- hot water temperature limiter, can be preset
- WRAS 1906098

| | | |
|--|--------------------------------|---------------|
|  | Dark Chrome | 36 426 892-19 |
|  | Chrome | 36 426 892-00 |
|  | Brushed Platinum | 36 426 892-06 |
|  | Platinum | 36 426 892-08 |
|  | Brushed Durabronze (23kt Gold) | 36 426 892-28 |
|  | Matte Black | 36 426 892-33 |
|  | Brushed Bronze | 36 426 892-42 |
|  | Brushed Champagne (22kt Gold) | 36 426 892-46 |
|  | Champagne (22kt Gold) | 36 426 892-47 |
|  | Brushed Chrome | 36 426 892-93 |
|  | Brushed Dark Platinum | 36 426 892-99 |

Required miscellaneous



Concealed thermostat -

35 425 970 90

- max. recess depth 136 mm
- min. recess depth 80 mm

36 426 892

mm [inches]

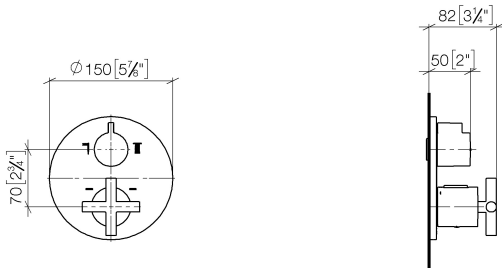

Flow rate chart

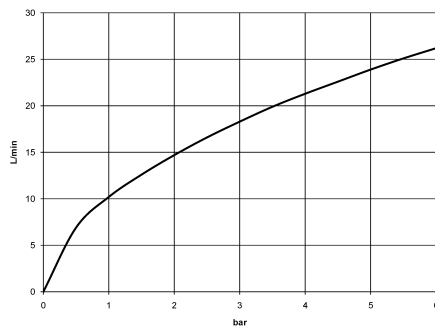

Codes & Standards

DIN 4109

ISO 3822

Scottish Water
Byelaws

UK Water Supply
Regulations

Ü-Zeichen



TARA Concealed thermostat with two function volume control - Dark Chrome

TARA

36 426 892

Certificates

WRAS_1906

LGA_19

LGA_19

Product version from 5/1/2022

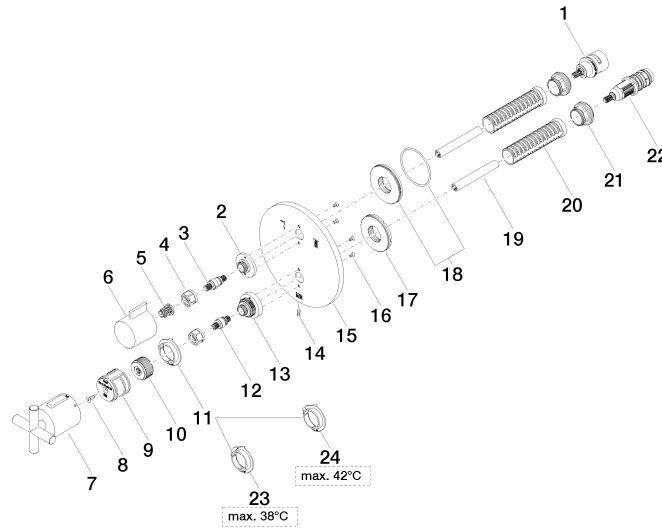



TARA Concealed thermostat with two function volume control - Dark Chrome

TARA

36 426 892

Spare parts list

Product version from 5/1/2022

| No. | Item Number | Name | Quantity used | Delivery time |
|-----|--------------------|----------|---------------|---------------|
| | 90 90 03 163 00 90 | diverter | 31 | 2 |