







**CYO Wall valve clockwise closing 1/2" - Platinum / Brushed Platinum** CYO

36 607 811



- without rosette
- handle Ø 60mm
- head part with cut-to-length spindle and sleeve

NOTE: The handle inserts must be ordered separately from the fittings!

	Platinum / Brushed Platinum	36 607 811-36
	Chrome	36 607 811-00
	Brushed Platinum	36 607 811-06
	Dark Chrome	36 607 811-19
	Brushed Durabass (23kt Gold)	36 607 811-28
	Durabass / Brushed Durabass (23kt Gold)	36 607 811-38
	Brushed Dark Platinum	36 607 811-99



CYO Wall valve clockwise closing 1/2" - Platinum / Brushed Platinum

CYO

36 607 811

mm [inches]



Codes & Standards

DIN 4109	ISO 3822	Ü-Zeichen
----------	----------	-----------

Certificates

LGA\_38

Parts for other  
finishes can be found  
here: [Chrome](#)

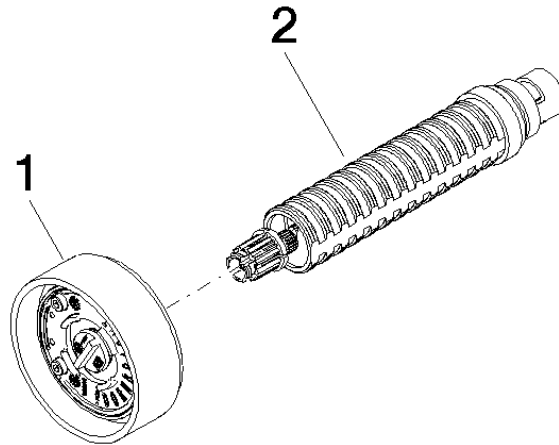



CYO Wall valve clockwise closing 1/2" - Platinum / Brushed Platinum

CYO

36 607 811

Spare parts list

No.	Item Number	Name	Quantity used	Delivery time
	90 18 40 291 01-36	handle	2	20