

VAIA Two-hole bridge mixer with rinsing spray set - Chrome

VAIA

ST 110 202 7809



- 241mm projection
- pivotable spout 360°
- air-enriched flow and spray flow
- fabric braided hose 1500 mm
- automatic spout/shower diverter
- sprayface with anti-scaling system
- max. flow 7 l/min at 3 bar flow pressure
- lead-free
- This product can help a building meet the requirements of Green Building Rating Systems, e.g. LEED®, BREEAM®, DGNB

| | | |
|--|-------------------------------|--------------------|
| | Chrome | ST 110 202 7809-00 |
| | Brushed Platinum | ST 110 202 7809-06 |
| | Platinum | ST 110 202 7809-08 |
| | Durabrass (23kt Gold) | ST 110 202 7809-09 |
| | Dark Chrome | ST 110 202 7809-19 |
| | Brushed Durabrass (23kt Gold) | ST 110 202 7809-28 |
| | Matte Black | ST 110 202 7809-33 |
| | Brushed Champagne (22kt Gold) | ST 110 202 7809-46 |
| | Champagne (22kt Gold) | ST 110 202 7809-47 |
| | Brushed Chrome | ST 110 202 7809-93 |
| | Brushed Dark Platinum | ST 110 202 7809-99 |

Individual components of this set

You need the following components for this set



1x 19 825 809-00



1x 27 731 809-00

VAIA Two-hole bridge mixer with rinsing spray set - Chrome

VAIA

ST 110 202 7809



- 241mm projection
- pivotable spout 360°
- air-enriched flow
- max. flow 7 l/min at 3 bar flow pressure
- lead-free
- This product can help a building meet the requirements of Green Building Rating Systems, e.g. LEED®, BREEAM®, DGNB

| | | |
|--|-------------------------------|--------------|
|  | Chrome | 19 825 809-0 |
|  | Brushed Platinum | 19 825 809-0 |
|  | Platinum | 19 825 809-0 |
|  | Durabrand (23kt Gold) | 19 825 809-0 |
|  | Dark Chrome | 19 825 809-1 |
|  | Brushed Durabrand (23kt Gold) | 19 825 809-2 |
|  | Matte Black | 19 825 809-3 |
|  | Brushed Champagne (22kt Gold) | 19 825 809-4 |
|  | Champagne (22kt Gold) | 19 825 809-4 |
| | Brushed Chrome | 19 825 809-9 |
|  | Brushed Dark Platinum | 19 825 809-9 |

ST 110 202 7809

0
—
6
—
8
—
9
—
9
—
8
—
3
—
6
—
7
—
3
—
9
—

Recommended miscellaneous

VAIA Dispenser with rosette - 82 434 809-00
Chrome



ST 110 202 7809

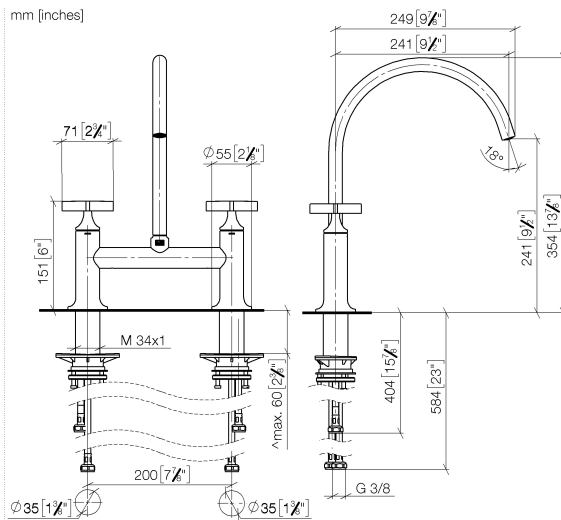

Flow rate chart

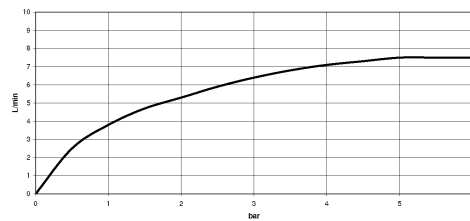

Certificates

LGA_38

Codes & Standards

DIN 4109

ISO 3822

Ü-Zeichen

Product version from 7/1/2023

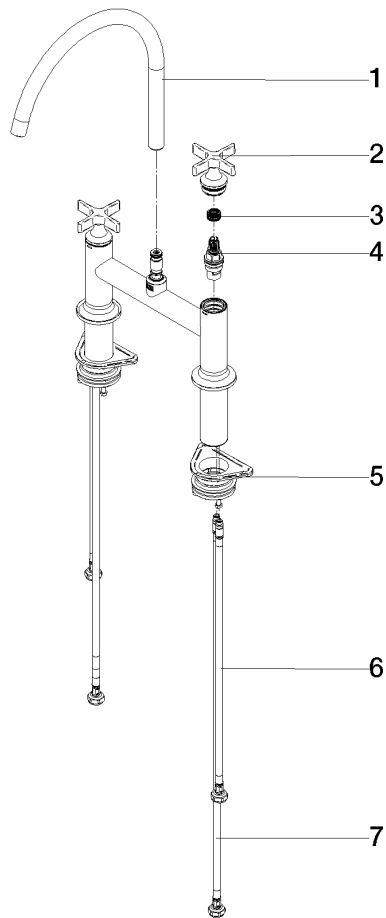



VAIA Two-hole bridge mixer with rinsing spray set - Chrome

VAIA

ST 110 202 7809

Spare parts list

Product version from 7/1/2023

| No. | Item Number | Name | Quantity used | Delivery time |
|-----|--------------------|-------|---------------|---------------|
| | 90 28 22 396 00-00 | spout | 13 | 10 |

VAIA Two-hole bridge mixer with rinsing spray set - Chrome

VAIA

ST 110 202 7809



- with round rosette
- spray flow
- automatic spout/shower diverter
- height of mixer 202 mm
- hole diameter rinsing spray 32mm
- fabric braided hose 1500 mm
- sprayface with anti-scaling system
- lead-free

Can only be combined with 33810809, 33826809, 19815809, 19825809.

Intrinsic protection against back flow.

Residual water may emerge from the spray after closing.

Operating unit can be positioned freely.

| | | |
|--|-------------------------------|--------------|
|  | Chrome | 27 731 809-0 |
|  | Brushed Platinum | 27 731 809-0 |
|  | Platinum | 27 731 809-0 |
|  | Durabrand (23kt Gold) | 27 731 809-0 |
|  | Dark Chrome | 27 731 809-1 |
|  | Brushed Durabrand (23kt Gold) | 27 731 809-2 |
|  | Matte Black | 27 731 809-3 |
|  | Brushed Champagne (22kt Gold) | 27 731 809-4 |
|  | Champagne (22kt Gold) | 27 731 809-4 |
|  | Brushed Chrome | 27 731 809-9 |
|  | Brushed Dark Platinum | 27 731 809-9 |

ST 110 202 7809

0
—
6
—
8
—
9
—
9
—
8
—
3
—
6
—
7
—
3
—
9
—

ST 110 202 7809

mm [inches]

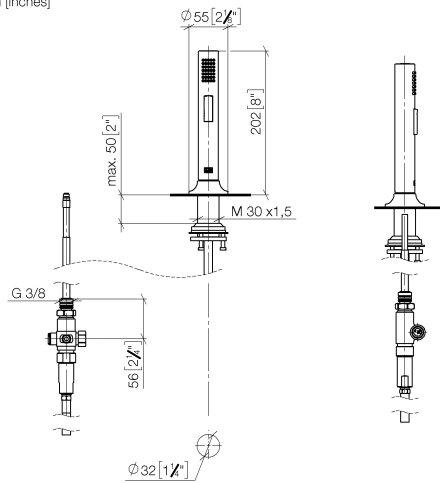

Certificates

Belgaqua_24-005-2

Codes & Standards

EN 1717

Spare parts list