





Angle valve - Durabrand (23kt Gold)

SERIES SPECIFIC

22 901 979 Product version up to 5/27/2021



- rosette Ø 55 mm
- hose covering 200mm, for shortening
- WRAS

| | | |
|---|-------------------------------|---------------|
|  | Durabrand (23kt Gold) | 22 901 979-09 |
|  | Chrome | 22 901 979-00 |
|  | Brushed Platinum | 22 901 979-06 |
|  | Platinum | 22 901 979-08 |
|  | Dark Chrome | 22 901 979-19 |
|  | Brushed Durabrand (23kt Gold) | 22 901 979-28 |
|  | Matte Black | 22 901 979-33 |
|  | Brushed Champagne (22kt Gold) | 22 901 979-46 |
|  | Champagne (22kt Gold) | 22 901 979-47 |
|  | Brushed Chrome | 22 901 979-93 |
|  | Brushed Dark Platinum | 22 901 979-99 |

22 901 979 Product version up to 5/27/2021

mm [inches]



Flow rate chart



Codes & Standards

Scottish Water
Byelaws

UK Water Supply
Regulations



Angle valve - Durabrace (23kt Gold)

SERIES SPECIFIC

22 901 979 Product version up to 5/27/2021

Certificates and sustainability

WRAS_2205

22 901 979
Product version up to 5/27/2021

Parts for other
finishes can be found
here: Chrome

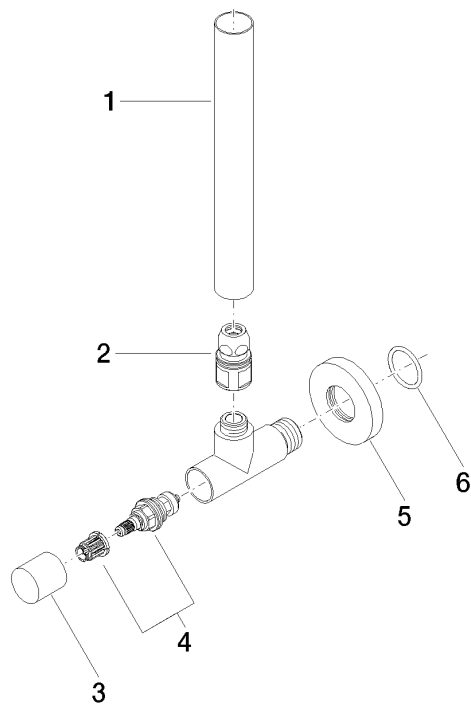

Spare parts list

| No. | Item Number | Name | Quantity used | Delivery time |
|-----|--------------------|----------------|---------------|---------------|
| 3 | 09 20 22 001-09 | handle | 1.00 | 40 |
| 5 | 09 27 22 015-09 | rosette | 1.00 | 40 |
| 1 | 09 28 22 020-09 | pipe | 1.00 | 40 |
| 2 | 90 24 03 276 00 90 | conversion kit | 1.00 | 2 |
| 4 | 90 90 03 006 00 90 | top | 1.00 | 2 |
| 6 | 09 14 10 093 90 | seal | 1.00 | 2 |