

Hand shower FlowReduce - Brushed Platinum

IMO

28 012 979



- Four settings: COMPACT RAIN, COMPACT SOFT FLOW, COMPACT AQUAPRESSURE FLOW, COMPACT CASCADE, max. flow rate 6.8 l/min (at 3 bar)
- with anti-scale system
- spray head Ø 120mm
- 1/2" connection
- This product can help a building meet the requirements of Green Building Rating Systems, e.g. LEED®, BREEAM®, DGNB

Intrinsic protection against back flow.

Fits: IMO, LULU, MADISON, MEM, TARA, CL.1, LISSÉ, VAIA, META, CYO

| | | |
|--|-------------------------------|--------------------|
| | Brushed Platinum | 28 012 979-06 0010 |
| | Chrome | 28 012 979-00 0010 |
| | Chrome | 28 012 979-00 |
| | Brushed Platinum | 28 012 979-06 |
| | Platinum | 28 012 979-08 0010 |
| | Platinum | 28 012 979-08 |
| | Dark Chrome | 28 012 979-19 |
| | Dark Chrome | 28 012 979-19 0010 |
| | Light Gold | 28 012 979-26 |
| | Light Gold | 28 012 979-26 0010 |
| | Brushed Light Gold | 28 012 979-27 |
| | Brushed Light Gold | 28 012 979-27 0010 |
| | Brushed Durabress (23kt Gold) | 28 012 979-28 |
| | Brushed Durabress (23kt Gold) | 28 012 979-28 0010 |
| | Matte Black | 28 012 979-33 0010 |
| | Matte Black | 28 012 979-33 |
| | Brushed Bronze | 28 012 979-42 0010 |
| | Brushed Bronze | 28 012 979-42 |
| | Brushed Champagne (22kt Gold) | 28 012 979-46 0010 |
| | Brushed Champagne (22kt Gold) | 28 012 979-46 |
| | Champagne (22kt Gold) | 28 012 979-47 |
| | Champagne (22kt Gold) | 28 012 979-47 0010 |
| | Brushed Chrome | 28 012 979-93 |
| | Brushed Chrome | 28 012 979-93 0010 |
| | Brushed Dark Platinum | 28 012 979-99 |
| | Brushed Dark Platinum | 28 012 979-99 0010 |



Hand shower FlowReduce - Brushed Platinum

IMO

28 012 979

28 012 979

mm [inches]



Flow rate chart



Codes & Standards

ASME A112.18.1

cUPC

DIN 4109

ISO 3822

Ü-Zeichen



Hand shower FlowReduce - Brushed Platinum

IMO

28 012 979

Certificates

IAPMO_4976

LGA_29

28 012 979

Product version from 4/1/2024

Parts for other
finishes can be found
here: [Chrome](#)

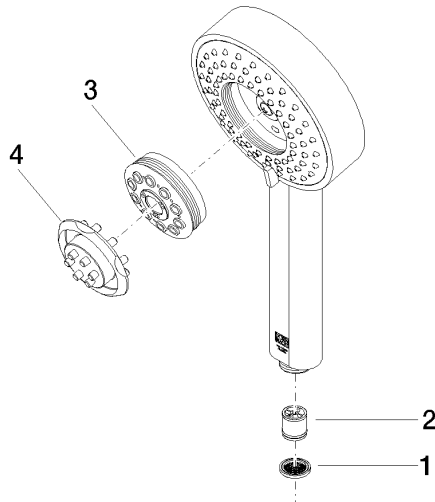



Hand shower FlowReduce - Brushed Platinum

IMO

28 012 979

Spare parts list

Product version from 4/1/2024

| No. | Item Number | Name | Quantity used | Delivery time |
|-----|-----------------|-------|---------------|---------------|
| | 09 23 01 039 90 | sieve | 4 | 2 |