

28 450 809



- 3/8" shower outlet
- rosette Ø 60 mm
- 1/2" connection
- WRAS 1810006

Intrinsic protection against back flow.

| | | |
|---|--------------------------------|---------------|
|  | Brushed Dark Platinum | 28 450 809-99 |
|  | Chrome | 28 450 809-00 |
|  | Brushed Platinum | 28 450 809-06 |
|  | Platinum | 28 450 809-08 |
|  | Dark Chrome | 28 450 809-19 |
|  | Brushed Durabronze (23kt Gold) | 28 450 809-28 |
|  | Brushed Bronze | 28 450 809-42 |
|  | Brushed Champagne (22kt Gold) | 28 450 809-46 |
|  | Champagne (22kt Gold) | 28 450 809-47 |

Recommended miscellaneous



Concealed wall elbow -

35 085 970 90

- max. recess depth 163 mm
- min. recess depth 90 mm

28 450 809

mm [inches]

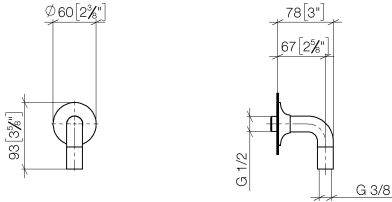

Flow rate chart

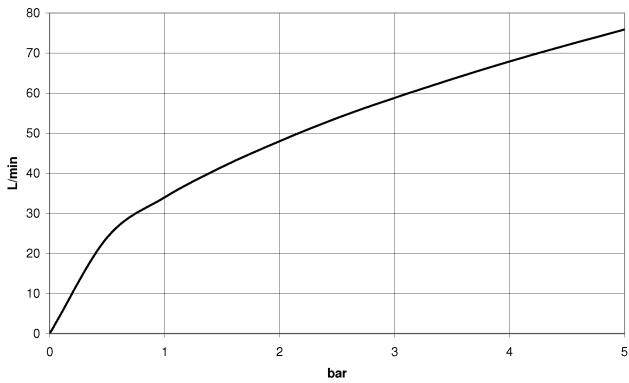

Codes & Standards

ASME A112.18.1

cUPC

EN 1717

Scottish Water
Byelaws

UK Water Supply
Regulations



VAIA Wall elbow - Brushed Dark Platinum

VAIA

28 450 809

Certificates

IAPMO_4976

WRAS_1810

Belgaqua_22_280_2

28 450 809

Product version from 3/13/2017 to 7/6/2018

Product version from 7/6/2018

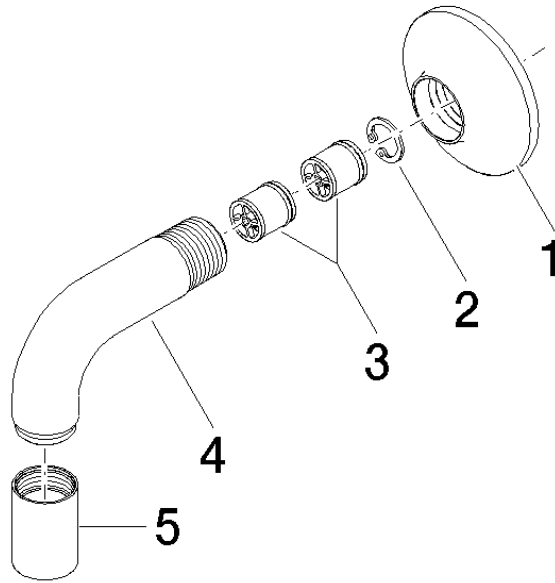



VAIA Wall elbow - Brushed Dark Platinum

VAIA

28 450 809

Spare parts list

Product version from 3/13/2017 to 7/6/2018

Product version from 7/6/2018

| No. | Item Number | Name | Quantity used | Delivery time |
|-----|--------------------|---------|---------------|---------------|
| | 90 27 80 021 00-99 | rosette | 6 | 30 |