

META Wall-mounted valve cold water without pop-up waste - Brushed Champagne (22kt Gold)

META

30 010 662 Product version from 5/1/2022



- 126mm projection
- fixed spout
- circular, air-enriched flow
- hole diameter 35 mm
- rosette Ø 60 mm
- max. flow 5.7 l/min
- lead-free
- This product can help a building meet the requirements of Green Building Rating Systems, e.g. LEED®, BREEAM®, DGNB

| | | |
|---|-------------------------------|---------------|
|  | Brushed Champagne (22kt Gold) | 30 010 662-46 |
|  | Chrome | 30 010 662-00 |
|  | Brushed Platinum | 30 010 662-06 |
|  | Dark Chrome | 30 010 662-19 |
|  | Light Gold | 30 010 662-26 |
|  | Brushed Light Gold | 30 010 662-27 |
|  | Matte Black | 30 010 662-33 |
|  | Brushed Dark Brass | 30 010 662-39 |
|  | Brushed Bronze | 30 010 662-42 |
|  | Champagne (22kt Gold) | 30 010 662-47 |
|  | Brushed Chrome | 30 010 662-93 |
|  | Brushed Dark Platinum | 30 010 662-99 |

**META Wall-mounted valve cold water without pop-up waste - Brushed
Champagne (22kt Gold)**

META

30 010 662 Product version from 5/1/2022
mm [inches]



Flow rate chart



Codes & Standards

DIN 4109 ISO 3822 Ü-Zeichen



META Wall-mounted valve cold water without pop-up waste - Brushed Champagne (22kt Gold)

META

30 010 662 Product version from 5/1/2022

Certificates and sustainability

LGA_38

META Wall-mounted valve cold water without pop-up waste - Brushed Champagne (22kt Gold)

META

30 010 662 Product version from 5/1/2022

Parts for other
finishes can be found
here: [Chrome](#)

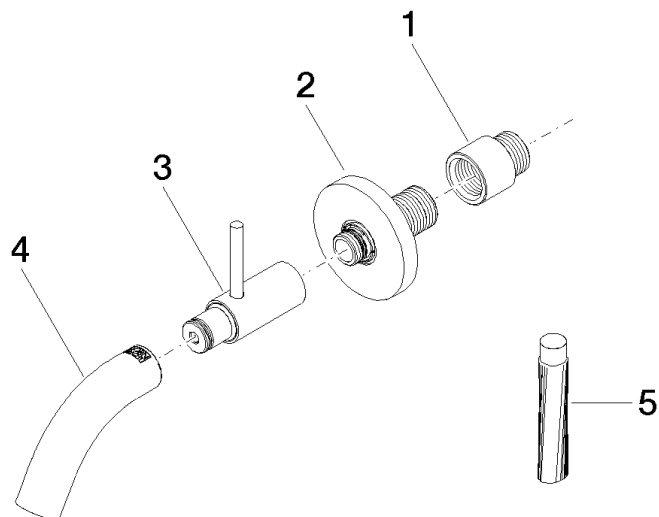

Spare parts list

| No. | Item Number | Name | Quantity used | Delivery time |
|-----|--------------------|---------|---------------|---------------|
| 1 | 09 24 03 072 10 90 | nipple | 1.00 | 2 |
| 2 | 90 27 66 019 00-46 | rosette | 1.00 | 30 |
| 3 | 90 20 66 023 00-46 | handle | 1.00 | 30 |
| 4 | 90 28 22 385 00-46 | spout | 1.00 | 30 |
| 5 | 09 16 03 001 90 | grease | 1.00 | 2 |