

## TARA ULTRA Single-lever mixer - Brushed Champagne (22kt Gold)

TARA ULTRA

33 800 875 Product version from 6/1/2022



- 201mm projection
- pivotable spout 360°
- air-enriched flow
- height of mixer 373 mm
- height up to aerator 240 mm
- hole diameter 35 mm
- max. flow 8 l/min at 3 bar flow pressure
- lead-free
- This product can help a building meet the requirements of Green Building Rating Systems, e.g. LEED®, BREEAM®, DGNB
- WRAS

|   |                               |               |
|---|-------------------------------|---------------|
|    | Brushed Champagne (22kt Gold) | 33 800 875-46 |
|    | Chrome                        | 33 800 875-00 |
|    | Brushed Platinum              | 33 800 875-06 |
|    | Platinum                      | 33 800 875-08 |
|    | Durabrass (23kt Gold)         | 33 800 875-09 |
|    | Dark Chrome                   | 33 800 875-19 |
|    | Brushed Durabrass (23kt Gold) | 33 800 875-28 |
|    | Matte Black                   | 33 800 875-33 |
|    | Brushed Bronze                | 33 800 875-42 |
|   | Champagne (22kt Gold)         | 33 800 875-47 |
|  | Brushed Chrome                | 33 800 875-93 |
|  | Brushed Dark Platinum         | 33 800 875-99 |

### Recommended miscellaneous

**Dispenser without rosette -  
Brushed Champagne (22kt Gold)** 82 424 970-46



### Recommended miscellaneous

**Strainer waste with control handle  
- Brushed Champagne (22kt Gold)** 10 712 970-46



33 800 875    Product version from 6/1/2022

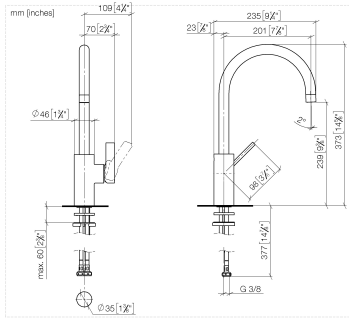

### Flow rate chart



## Codes & Standards

DIN 4109

Executive Order  
no. 1007

ISO 3822

Ü-Zeichen



## TARA ULTRA Single-lever mixer - Brushed Champagne (22kt Gold)

TARA ULTRA

33 800 875 Product version from 6/1/2022

### Certificates and sustainability

GDV\_0400

LGA\_18

33 800 875 Product version from 6/1/2022

Parts for other  
finishes can be found  
here: [Chrome](#)

