

36 426 892



- rotary diverter with volume control and shut-off function
- cover plate Ø 150 mm
- temperature control handle with safety limit stop at 38°C
- hot water temperature limiter, can be preset
- WRAS 1906098

	Platinum	36 426 892-08
	Chrome	36 426 892-00
	Brushed Platinum	36 426 892-06
	Dark Chrome	36 426 892-19
	Brushed Durabronze (23kt Gold)	36 426 892-28
	Matte Black	36 426 892-33
	Brushed Bronze	36 426 892-42
	Brushed Champagne (22kt Gold)	36 426 892-46
	Champagne (22kt Gold)	36 426 892-47
	Brushed Chrome	36 426 892-93
	Brushed Dark Platinum	36 426 892-99

Required miscellaneous

	<b>Concealed thermostat -</b> ●min. recess depth 80 mm ●max. recess depth 136 mm	35 425 970 90
---	--	---------------

Required miscellaneous

	<b>Concealed thermostat with built-in isolators -</b> ●max. recess depth 136 mm ●min. recess depth 80 mm	35 426 970 90
---	--	---------------

Recommended miscellaneous

	<b>xGRID Attachment set for integrating in the dry wall construction -</b>	12 340 970 90
---	--	---------------

Required miscellaneous

	<b>xGRID Installation track 555 mm -</b>	12 360 970 90
---	--	---------------

36 426 892

mm [inches]

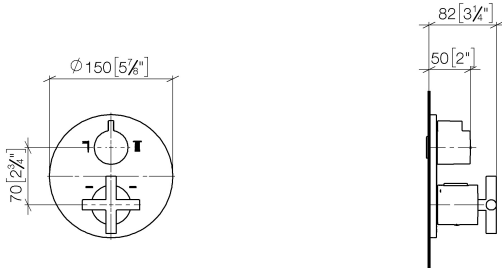

Flow rate chart

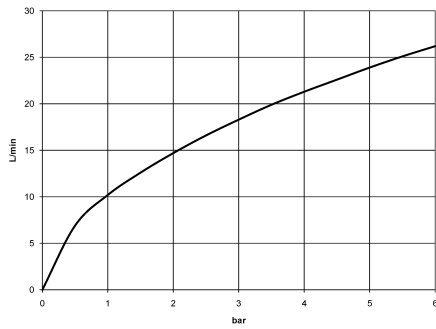

Codes & Standards

DIN 4109

ISO 3822

Scottish Water  
Byelaws

UK Water Supply  
Regulations

Ü-Zeichen



TARA Concealed thermostat with two function volume control - Platinum

TARA

36 426 892

Certificates

WRAS\_1906

LGA\_19

LGA\_19

36 426 892

Product version from 5/1/2022

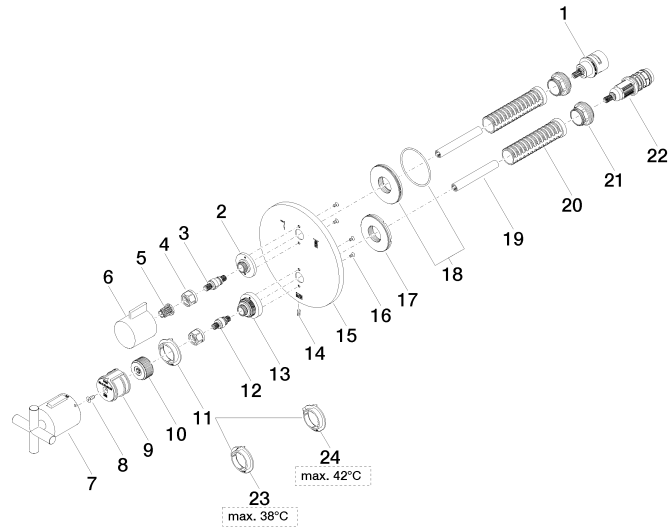



TARA Concealed thermostat with two function volume control - Platinum

TARA

36 426 892

**Spare parts list**

**Product version from 5/1/2022**

No.	Item Number	Name	Quantity used	Delivery time
	90 90 03 163 00 90	diverter	31	2