



WATER SHEET Cascade spout for wall-mounted installation - Dark Chrome

13 415 979



- 5-7/8" Projection
- CASCADE, flow rate max. 7 gpm (at 3 bar)
- Cover plate 9-1/2" x 2-3/8"
- 1/2" connection
- Plug-in connection mounting

	Dark Chrome	13 415 979-19
	Chrome	13 415 979-00
	Brushed Platinum	13 415 979-06
	Platinum	13 415 979-08
	Light gold	13 415 979-26
	Brushed Light Gold	13 415 979-27
	Brushed Durabrass (23kt Gold)	13 415 979-28
	Matte Black	13 415 979-33
	Brushed Bronze	13 415 979-42
	Brushed Champagne (22kt Gold)	13 415 979-46
	Champagne (22kt Gold)	13 415 979-47
	Brushed Chrome	13 415 979-93
	Brushed Dark Platinum	13 415 979-99

Required article

Rough-in adapter -

35 080 970-90
0010



WATER SHEET Cascade spout for wall-mounted installation - Dark Chrome

13 415 979

mm [inches]

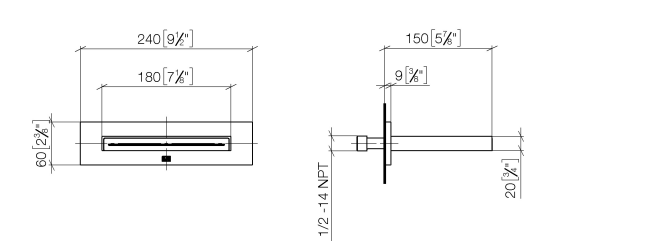

Flow rate chart

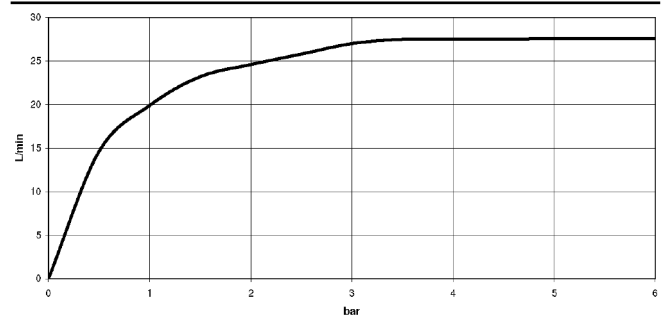

Trajectory length diagram

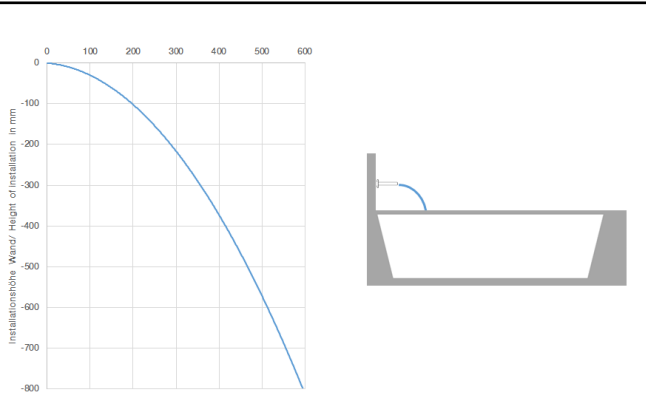

Codes & Standards

ASME A112.18.1	ASME A112.18.1/CSA B125.1	cUPC	Scottish Water Byelaws
UK Water Supply Regulations			



WATER SHEET Cascade spout for wall-mounted installation - Dark Chrome

13 415 979

Certificates

WRAS_2306

IAPMO_4976

WATER SHEET Cascade spout for wall-mounted installation - Dark Chrome

13 415 979

