

META Tub spout without diverter for freestanding installation - Chrome

13 672 661
Product version from 5/27/2021



- 11-1/8" Projection
- Round aerator
- Total height 31-7/8" - 34-5/8"
- Height to aerator/spout outlet 26-3/8" - 29-1/8"
- Flanges Ø 5-3/8"
- Water flow rate limited to max. 7.6 gpm

| | | |
|---|-----------------------|---------------|
|  | Chrome | 13 672 661-00 |
|  | Brushed Platinum | 13 672 661-06 |
|  | Dark Chrome | 13 672 661-19 |
|  | Light gold | 13 672 661-26 |
|  | Brushed Light Gold | 13 672 661-27 |
|  | Matte Black | 13 672 661-33 |
|  | Brushed Bronze | 13 672 661-42 |
|  | Brushed Chrome | 13 672 661-93 |
|  | Brushed Dark Platinum | 13 672 661-99 |

Required article



- Floor mounting rough set -**
 - Max. rough in depth "
 - Min. rough in depth "

35 949 970-90
0010

META Tub spout without diverter for freestanding installation - Chrome

13 672 661 Product version from 5/27/2021

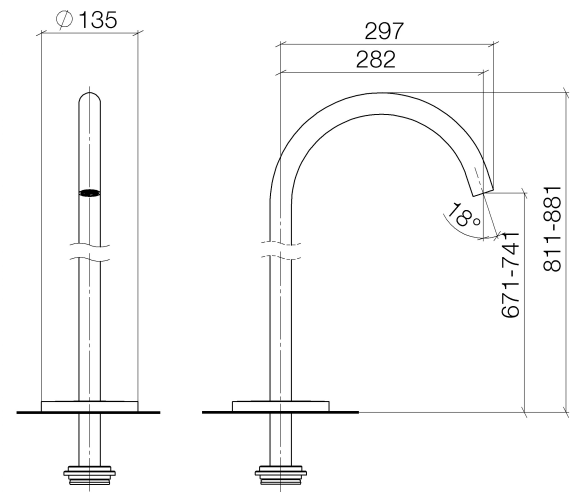

Flow rate chart

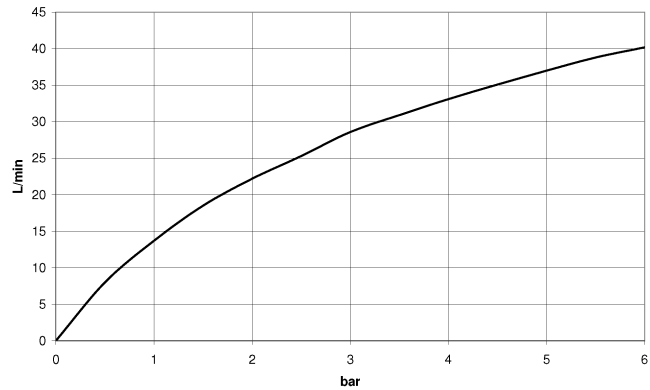

Codes & Standards

| | | | |
|----------------|---------------------------|-----------------------------|-----------|
| ASME A112.18.1 | ASME A112.18.1/CSA B125.1 | cUPC | DIN 4109 |
| ISO 3822 | Scottish Water Byelaws | UK Water Supply Regulations | Ü-Zeichen |



META Tub spout without diverter for freestanding installation - Chrome

13 672 661 Product version from 5/27/2021

Certificates

| | | |
|--------|-----------|------------|
| LGA_18 | WRAS_2001 | IAPMO_4976 |
|--------|-----------|------------|

META Tub spout without diverter for freestanding installation - Chrome

13 672 661 Product version from 5/27/2021

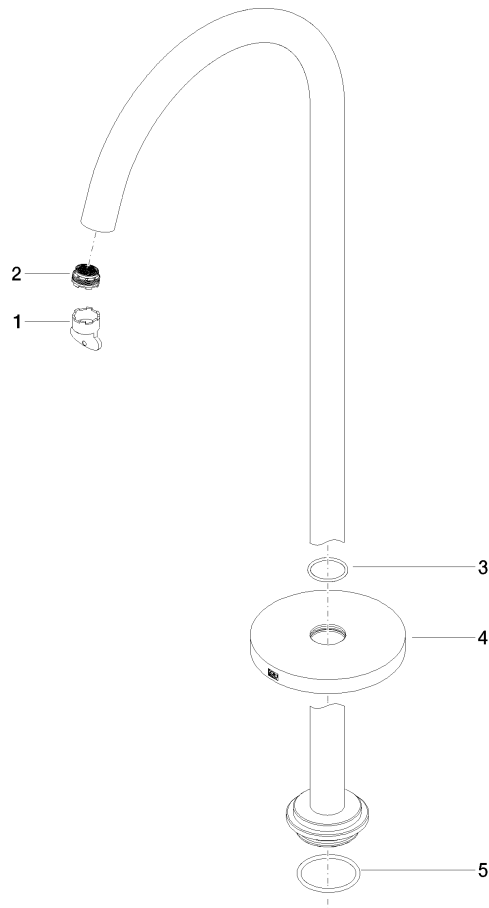

Spare parts list

| Number | Item Number | Designation | Number of units | Lead time |
|--------|--------------------|-------------|-----------------|-----------|
| 1 | 04 30 09 027 00 90 | key | 1 | 2 |
| 2 | 09 29 03 127 90 | aerator | 1 | 60 |
| 3 | 09 14 10 101 90 | seal | 1 | 2 |
| 4 | 09 27 85 003-00 | rosette | 1 | 10 |
| 5 | 09 14 10 084 90 | seal | 1 | 2 |