









MEM Tub spout without diverter for freestanding installation - Dark Chrome

13 672 780

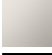

- 11" Projection
- Cascade
- Total height 32-5/8" - 35-3/8"
- Height to aerator/spout outlet 26-1/8" - 28-7/8"
- Flange 5-1/8" x 5-1/8"
- Water flow rate limited to max. 12.6 gpm

	Dark Chrome	13 672 780-19
	Chrome	13 672 780-00
	Brushed Platinum	13 672 780-06
	Platinum	13 672 780-08
	Brushed Durabrass (23kt Gold)	13 672 780-28
	Brushed Champagne (22kt Gold)	13 672 780-46
	Champagne (22kt Gold)	13 672 780-47

MEM Tub spout without diverter for freestanding installation - Dark Chrome

13 672 780

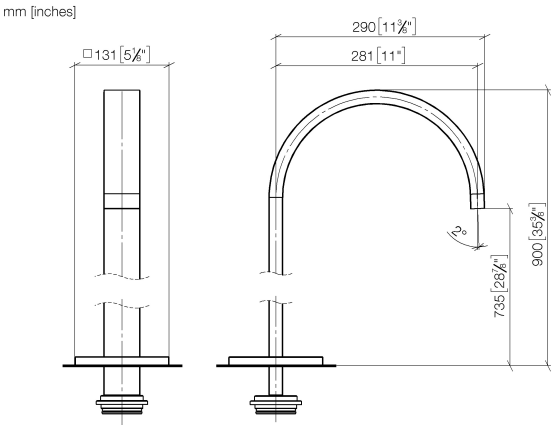

Flow rate chart

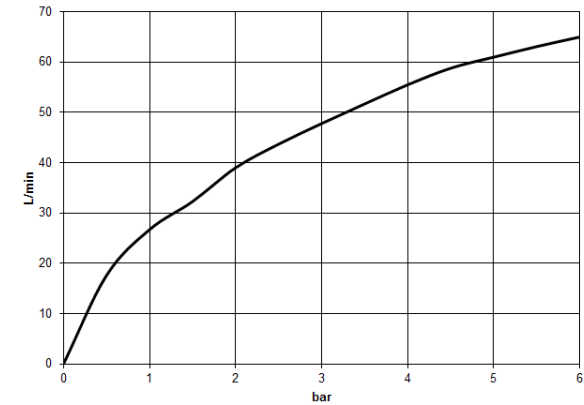

Codes & Standards

ASME A112.18.1	ASME A112.18.1/CSA B125.1	cUPC	DIN 4109
ISO 3822	Ü-Zeichen		



MEM Tub spout without diverter for freestanding installation - Dark Chrome

---

13 672 780

Certificates

---

IAPMO\_4976      LGA\_18

## MEM Tub spout without diverter for freestanding installation - Dark Chrome

---

13 672 780

Parts for other  
finishes can be found  
here: [Chrome](#)

