







CL.1 Lavatory spout, wall-mounted without drain - Champagne (22kt Gold)

13 800 705 Product version from 3/9/2015



- 7-7/8" Projection
- Rigid spout
- Rectangular aerator with 40 individual streams
- 1-1/2" hole diameter
- lead-free
- 1/2" connection
- Plug-in connection mounting
- Water flow rate limited to max. 1.2 gpm
- This product can help a building meet the requirements of Green Building Rating Systems, e.g. LEED®, BREEAM®, DGNB

	Champagne (22kt Gold)	13 800 705-47
	Chrome	13 800 705-00
	Brushed Platinum	13 800 705-06
	Dark Chrome	13 800 705-19
	Brushed Champagne (22kt Gold)	13 800 705-46
	Brushed Dark Platinum	13 800 705-99



CL.1 Lavatory spout, wall-mounted without drain - Champagne (22kt Gold)

13 800 705 Product version from 3/9/2015

mm [inches]

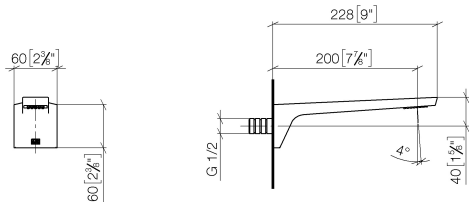

Flow rate chart

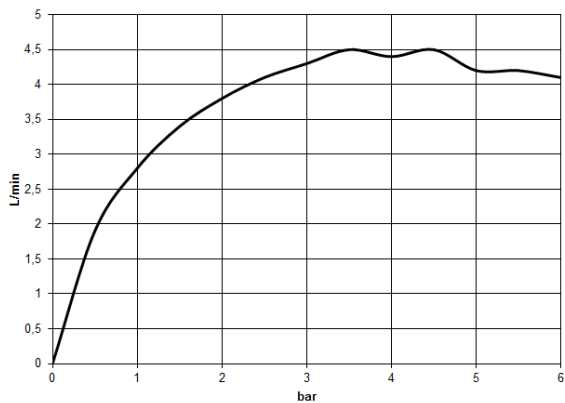

Codes & Standards

ASME A112.18.1/CSA B125.1	California Energy Commission (CEC)	EPA WaterSense	NSF/ANSI 372
NSF/ANSI/CAN 61	NSF372	NSF61	Water Sense

WaterSense





CL.1 Lavatory spout, wall-mounted without drain - Champagne (22kt Gold)

13 800 705 Product version from 3/9/2015

Certificates

IAPMO_N-4 IAPMO_8834 IAPMO_6

CL.1 Lavatory spout, wall-mounted without drain - Champagne (22kt Gold)

13 800 705 Product version from 3/9/2015

Parts for other
finishes can be found
here: [Chrome](#)

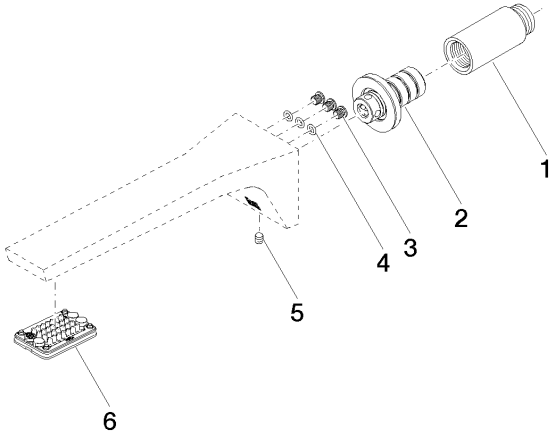

Spare parts list

Number	Item Number	Designation	Number of units	Lead time
1	09 24 03 081 10 90	extension	1	2
2	90 24 03 108 01 90	nipple set	1	2
3	09 30 30 113 20 90	screw	3	2
4	09 14 10 001 90	seal	3	2
5	90 31 11 004 00 90	pin	1	2
6	90 11 02 297 00 90	aerator	1	2